

INSTALLATION INSTRUCTIONS

for USK 500

"Flood-Seal"® Mechanical Splice Kit

- A direct-buried mechanical splice with a cable range of 2/0 to 500 Kcmil.
- Insulated in a "Flood-Seal" EPDM cover.

1 Select the correct cut-off ring for the cable being used.

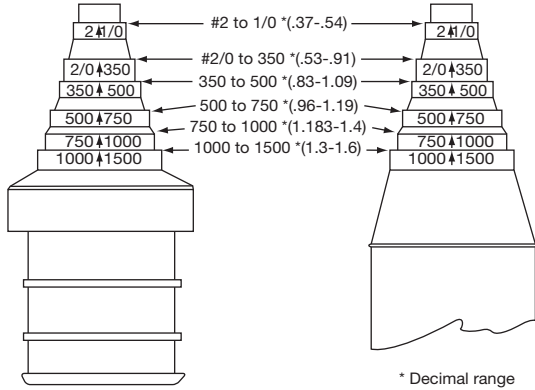

2 Cut off the rocket at the tip of the arrow, leaving the correct cable size showing on the opened rocket.



3 Wipe the cable clean. Bevel the end of the cable insulation for ease of installation.



4 Apply silicone grease to the end of the cable and the cut opening of the rocket. Slide the rocket over the prepared cable. Repeat steps 2, 3 and 4 on the cap.

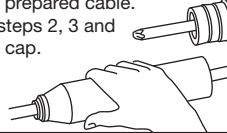

5 Strip the cable insulation for installation of the connector, baring approximately 2-1/4" of cable.

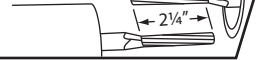

WIRE SIZE
2/0 - 350 Kcmil
400 - 500 Kcmil
UL Applications Torque

TORQUE
240 in-lbs (20 ft-lbs)
360 in-lbs (30 ft-lbs)
270 in-lbs

6 Install the connector to the suggested torque using a 5/16" hex wrench.

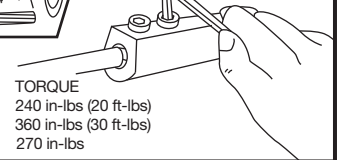

7 Apply silicone grease to the open edge of the rocket. Center the connector between the cap and rocket. Slide the covers together.

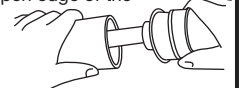

Thomas & Betts

Limited Warranty Applies. Refer to: www.tnb.com/ecpwarranty for full warranty terms.

Thomas & Betts Corporation
Memphis, Tennessee
www.tnb.com

0014654 A
104_R4
Page 1 of 1

© 2012 Thomas & Betts. All Rights Reserved.

INSTALLATION INSTRUCTIONS

for USK 500

"Flood-Seal"® Mechanical Splice Kit

- A direct-buried mechanical splice with a cable range of 2/0 to 500 Kcmil.
- Insulated in a "Flood-Seal" EPDM cover.

1 Select the correct cut-off ring for the cable being used.

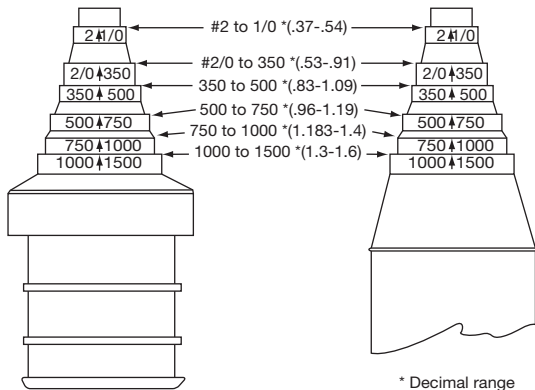

2 Cut off the rocket at the tip of the arrow, leaving the correct cable size showing on the opened rocket.

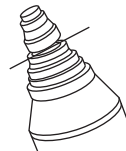

3 Wipe the cable clean. Bevel the end of the cable insulation for ease of installation.



4 Apply silicone grease to the end of the cable and the cut opening of the rocket. Slide the rocket over the prepared cable. Repeat steps 2, 3 and 4 on the cap.

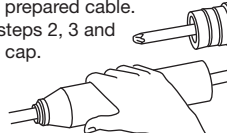

5 Strip the cable insulation for installation of the connector, baring approximately 2-1/4" of cable.



WIRE SIZE
2/0 - 350 Kcmil
400 - 500 Kcmil
UL Applications Torque

TORQUE
240 in-lbs (20 ft-lbs)
360 in-lbs (30 ft-lbs)
270 in-lbs

6 Install the connector to the suggested torque using a 5/16" hex wrench.

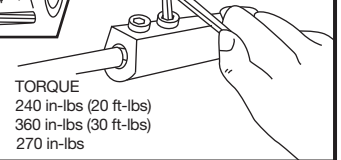

7 Apply silicone grease to the open edge of the rocket. Center the connector between the cap and rocket. Slide the covers together.

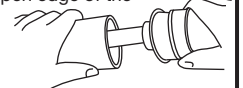

Thomas & Betts

Limited Warranty Applies. Refer to: www.tnb.com/ecpwarranty for full warranty terms.

Thomas & Betts Corporation
Memphis, Tennessee
www.tnb.com

0014654 A
104_R4
Page 1 of 1

© 2012 Thomas & Betts. All Rights Reserved.