





**WARNING**

Danger of Electric Shock! Installation of this product must be performed by trained installers in accordance with all applicable local, state and national electrical codes, installation standards and safety rules.



**WARNING**



## INSTALLATION INSTRUCTIONS

for "FLOOD-SEAL"® TWIN TAP COVER FSS 5035

### INSTRUCTION SHEET

- Eliminates taping: labor and material costs are significantly reduced.
- Indefinitely maintains watertight and full insulating value in all direct buried, underground network tap connections.
- Also recommended as a splice cover, easily converted to a tap cover when required and as a cable cap, available for insulating a splice or tap as construction proceeds.

**2**  
CUT OFF ROCKET SLEEVE AND CAP AT TIP OF ARROW LEAVING CORRECT CABLE SIZE SHOWING ON OPENED ROCKET AND CAP.



**3**  
WIPE CABLE CLEAN. BEVEL THE END OF CABLE INSULATION FOR EASE OF INSTALLATION. APPLY SILICONE GREASE TO END OF CABLE AND TO CUT OPENING OF INSULATING SLEEVE.

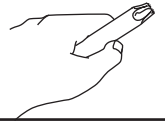

**4**  
INSERT CABLE UNTIL IT EXTENDS BEYOND THE INSULATING SLEEVE.

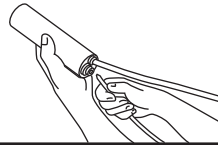

**5**  
STRIP INSULATION FROM CABLE END BARING CONDUCTOR.

REPEAT THIS STEP WITH CAP END.

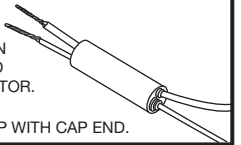

**6**  
INSTALL CONNECTOR.

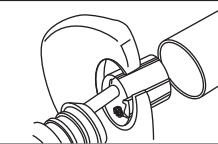

**7**  
APPLY SILICONE TO OPEN EDGE OF ROCKET, SLIDE TOGETHER.

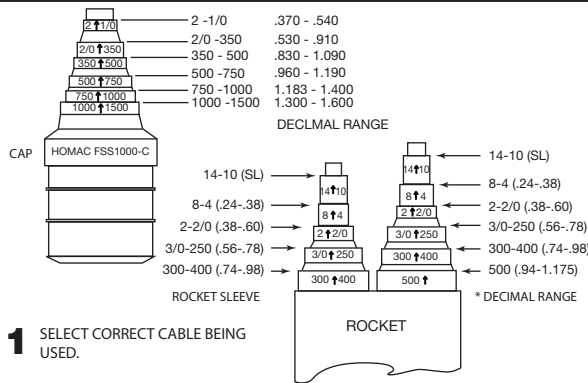
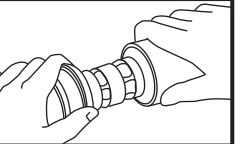

Limited Warranty Applies. Refer to:  
[www.tnb.com/ecpwarranty](http://www.tnb.com/ecpwarranty) for full warranty terms.

Thomas & Betts Corporation  
Memphis, Tennessee  
[www.tnb.com](http://www.tnb.com)

0015024 A  
141\_R2  
Page 1 of 1





**WARNING**

Danger of Electric Shock! Installation of this product must be performed by trained installers in accordance with all applicable local, state and national electrical codes, installation standards and safety rules.



**WARNING**



## INSTALLATION INSTRUCTIONS

for "FLOOD-SEAL"® TWIN TAP COVER FSS 5035

### INSTRUCTION SHEET

- Eliminates taping: labor and material costs are significantly reduced.
- Indefinitely maintains watertight and full insulating value in all direct buried, underground network tap connections.
- Also recommended as a splice cover, easily converted to a tap cover when required and as a cable cap, available for insulating a splice or tap as construction proceeds.

**2**  
CUT OFF ROCKET SLEEVE AND CAP AT TIP OF ARROW LEAVING CORRECT CABLE SIZE SHOWING ON OPENED ROCKET AND CAP.



**3**  
WIPE CABLE CLEAN. BEVEL THE END OF CABLE INSULATION FOR EASE OF INSTALLATION. APPLY SILICONE GREASE TO END OF CABLE AND TO CUT OPENING OF INSULATING SLEEVE.

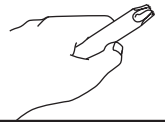

**4**  
INSERT CABLE UNTIL IT EXTENDS BEYOND THE INSULATING SLEEVE.

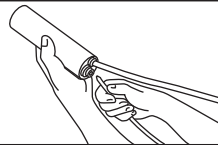

**5**  
STRIP INSULATION FROM CABLE END BARING CONDUCTOR.

REPEAT THIS STEP WITH CAP END.

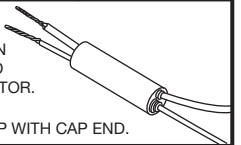

**6**  
INSTALL CONNECTOR.

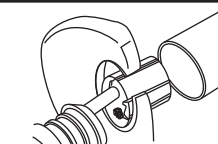

**7**  
APPLY SILICONE TO OPEN EDGE OF ROCKET, SLIDE TOGETHER.

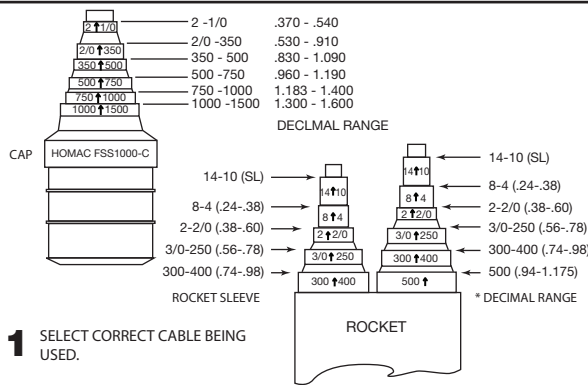
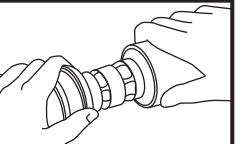

Limited Warranty Applies. Refer to:  
[www.tnb.com/ecpwarranty](http://www.tnb.com/ecpwarranty) for full warranty terms.

Thomas & Betts Corporation  
Memphis, Tennessee  
[www.tnb.com](http://www.tnb.com)

0015024 A  
141\_R2  
Page 1 of 1