

## INSTALLATION INSTRUCTIONS

FOR FTH 1-1/2" AND 3" SPLIT BASE SERIES INSTALLATION INSTRUCTION

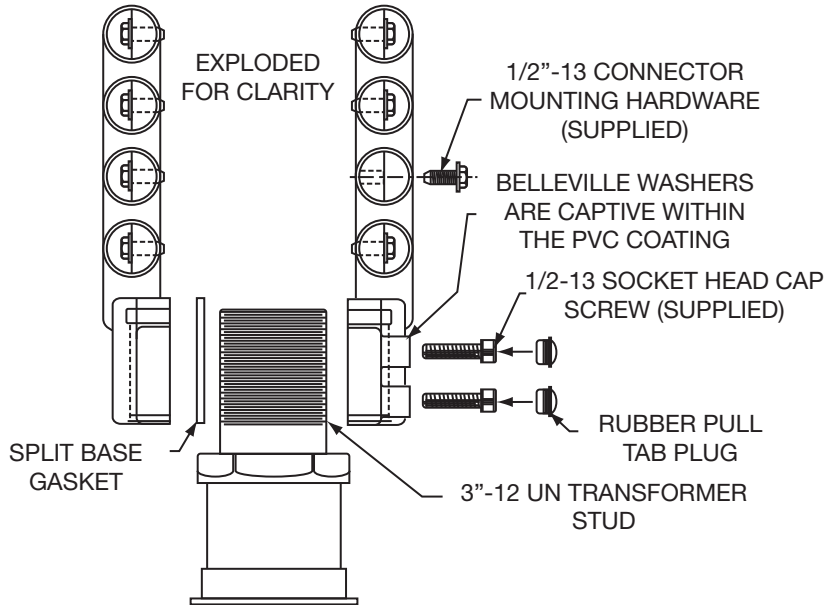

**FIGURE 1**  
(FTH 44-175-30 SHOWN)

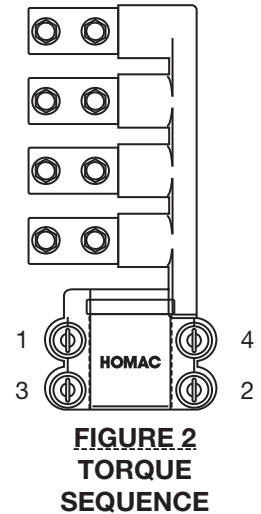
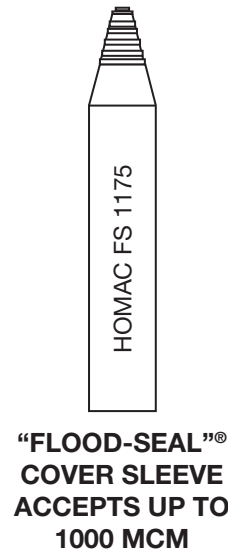

1. FS 1175 "FLOOD SEAL"® COVERS MUST BE INSTALLED ON CABLE PRIOR TO CRIMPING THE CONNECTORS.
2. REMOVE RUBBER PULL TAB PLUGS.
3. LOOSEN STUD MOUNTING BOLTS AND OPEN THE CONNECTOR AS FAR AS POSSIBLE WITHOUT DISENGAGING THE THREADS.
4. PLACE THE CONNECTOR OVER THE STUD TO ACCOMPLISH MAXIMUM THREAD ENGAGEMENT. CARE MUST BE TAKEN TO AVOID DAMAGE TO THE STUD THREADS.
5. PUSH THE CONNECTOR HALF WITH THE MOUNTING BOLT THREADS ONTO THE STUD THREADS, BE CAREFUL TO ENSURE FULL THREAD ENGAGEMENT.
6. PUSH THE OTHER CONNECTOR HALF ONTO THE STUD THREADS AND LIGHTLY SNUG THE BOLTS, FOLLOWING THE SEQUENCE SHOWN IN FIGURE 2.
7. CHECK THREAD ENGAGEMENT AND GASKET ALIGNMENT BEFORE PROCEEDING.
8. ROTATE THE CONNECTOR TO THE APPROXIMATE FINAL POSITION AND TORQUE TO 150 IN/LB FOLLOWING THE SEQUENCE SHOWN IN FIGURE 2.
9. INSTALL CONNECTORS TO NEMA PADS WITH THE SUPPLIED 1/2-13 BOLTS. SNUG THE BOLTS.
10. AS CABLES ARE INSTALLED MAKE ANY REQUIRED ADJUSTMENTS TO THE CONNECTOR POSITION.
11. AFTER ALL CABLES ARE INSTALLED AND SNUGGED, RESUME TORQUING THE STUD MOUNTING BOLTS TO 250 IN/LB AND THEN TO 360 IN/LB USING THE SEQUENCE SHOWN IN FIGURE 2.
12. RECHECK THE TORQUE OF EACH STUD MOUNTING BOLT IN SEQUENCE.
13. FINISH TORQUING THE CONNECTOR MOUNTING BOLTS TO 480 IN/LB (40 FT/LB) AND SLIDE THE FS 1175 FLOOD SEALS ONTO THE FTH 175 TO SEAL EACH CONNECTION.
14. REINSTALL THE RUBBER PULL TAB PLUGS.

Limited Warranty Applies. Refer to:  
[www.tnb.com/ecpwarranty](http://www.tnb.com/ecpwarranty) for full warranty terms.

**Thomas & Betts**

Thomas & Betts Corporation  
Memphis, Tennessee  
[www.tnb.com](http://www.tnb.com)