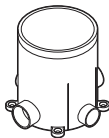

INSTALLATION INSTRUCTIONS

Floor box, round, non-metallic E971FB, E971FBCAR & E971FBL

Carlon®**CAUTION: Wear safety glasses.****CAUTION: Wear protective gloves.****Important**

Read and understand all instructions and safety information before use. Be aware of proper usage and potential hazards.

**Instructions – Steps to Install
Non-Metallic Floor Box in Cement:**

1. Installation in concrete:
 - a. Set floor box on level surface
 - b. Make connections into outlets by solvent cementing conduit into proper outlet in box.
 - c. Slip on throwaway plastic cap and seal unused outlets with solvent cemented plugs.

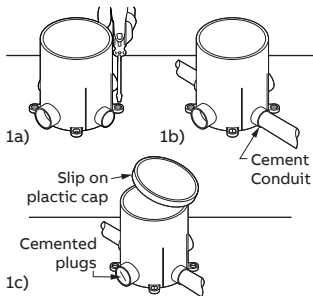

2. Trim out:

- a. After the cement has been poured and cured, remove plastic cap and determine thickness of flooring to be used. Scribe a line around floor box at this distance from floor.
- b. Using handsaw, cut off floor box at scribed line.

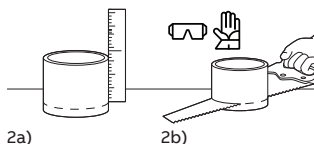

3. Install cover:

Refer to installation instructions provided with covers.

- a. Install non-metallic mounting ring to underside of cover.
- b. Apply PVC cement to the outside diameter of the mounting ring only. **DO NOT** apply any PVC cement between the cover and the leveling ring or between the cover and the box.
- c. Press mounting ring cover assembly into floor box, making sure cover assembly is seated in floor box.

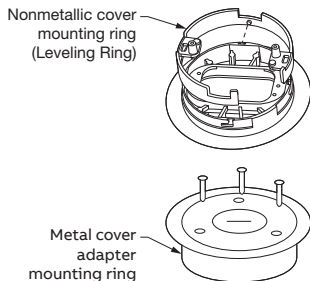

NOTE: Box may extend any distance above flooring. Box is cut off to exact height with a handsaw. Mounting ring assures a LEVEL top, every time.

3a)

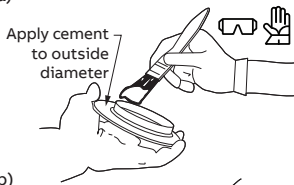

3c)

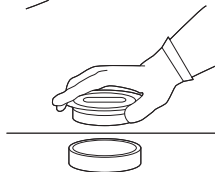

Instructions – Steps to Install Non-Metallic Floor Box in Wood & Metal Joist Construction:

1. Establish location of floor box on sub floor.
2. Cut a 5" round hole in sub floor.
3. Applications:
 - a. If electrical non-metallic tubing (ENT) is used for wiring, solvent weld ENT in hub using Carlon® ENT cement.
 - b. Cement the plugs provided in unused openings.
4. Cut wooden 2" x 6" support to fit between joist spacing. Refer to Figure 1 or Figure 2.
5. Secure floor box to the 2" x 6" with four (4) #10 x 1" screws. Refer to Figure 3 (**NOTE:** Screws are not provided).
6. From floor below, insert the floor box through the hole in sub floor to desired height. Secure support by using one of the following methods listed below.
 - a. Wooden joist construction: Use three (3) 16d nails on each side of floor joist to secure box support between wooden floor joists. Refer to Figure 3.
 - b. Metal joist construction: Use three (3) 3" self-drilling screws on each side of metal floor joist, to secure wooden box support between metal floor joists. Refer to Figure 3.
7. Follow floor box cover installation instructions provided with cover.

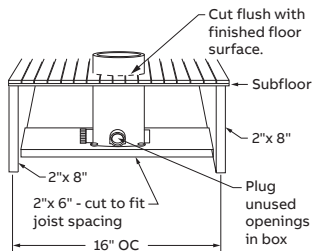

Figure 1 **WOOD JOIST CONSTRUCTION**

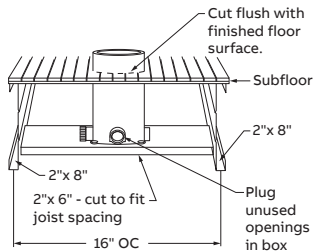
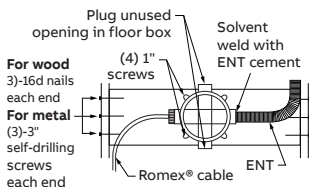

Figure 2 **METAL JOIST CONSTRUCTION**



Install box on 2" x 6", slide between floor joists, mark outline of box on bottom of subfloor, mark center - drill hole through floor to install box.

*Romex is a trademark of Southwire Company.

Figure 3

tnb.abb.com (US/Latin America)
tnb.ca.abb.com (Canada)
abb.com
Warranty:
tnb.abb.com/ecpwarrenty

We reserve the right to make technical changes or modify the contents of this document without prior notice. With regard to purchase orders, the agreed particulars shall prevail. ABB does not accept any responsibility whatsoever for potential errors or possible lack of information in this document.

We reserve all rights in this document and in the subject matter and illustrations contained therein. Any reproduction – in whole or in part – is forbidden without prior written consent of ABB. Copyright© 2020 ABB. All rights reserved.