

CABLE STRIPPING TOOL

Instructions for Cat. No. BCS8-40

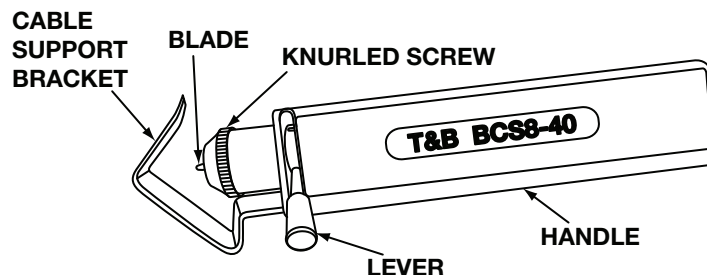

WARNING

DO NOT PLACE FINGERS BETWEEN THE CABLE SUPPORT BRACKET AND THE BLADE.

A. AJUSTING BLADE

NOTE: A sharp blade is contained beneath the cable support bracket of this tool. Upon raising the cable support bracket (as in steps 1 and 2), the blade will be exposed. Care should be used in inserting and removing the cable.

1. Push cable support bracket up with thumb and place cable within "V" of bracket so that end of cable is next to cutting blade, see Fig. 1.

Adjust depth of cutting blade to thickness of cable insulation by turning the knurled screw, see Fig. 1. **NOTE:** Care should be taken so that the cutting blade is not deep enough to be nick or cut the strands of the cable. If the strands appear to be nicked or cut, the blade should be lowered to the proper depth.

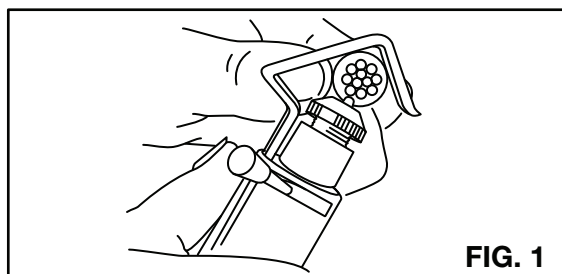

FIG. 1

2. Determine the length of insulation to be removed and mark the point where the cut should be made. Push cable support bracket up with thumb, see Fig.2. Insert the cable between "V" of support bracket and insulation cutting blade. Locate cable so that the mark is directly above the cutting blade.

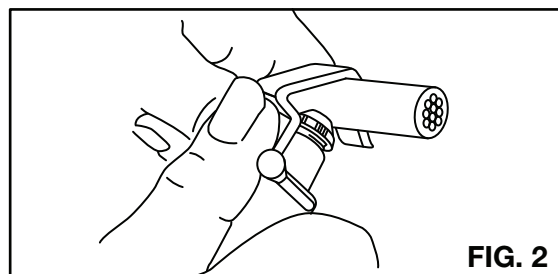

FIG. 2

NOTE: ALTERNATE METHOD, SEE FIG. 3 Hold stripping tool with end of cable support bracket facing you. Place cable under end of cable support bracket locating length of insulation to be removed directly in front of cutting blade. Pull stripping tool downward moving cable into the tool, under cable support bracket.

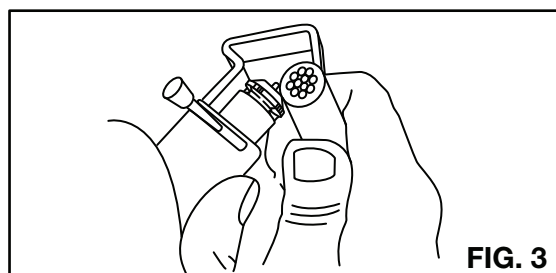

FIG. 3

3. Rotate stripping tool completely around the cable to cut the insulation; then, repeat rotation in reverse direction, see Fig. 4.

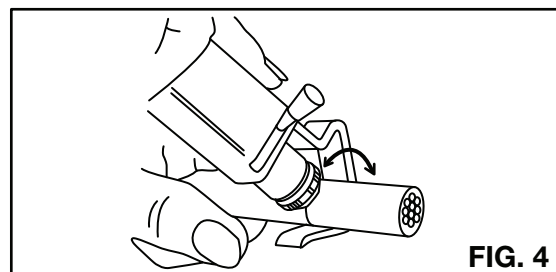

FIG. 4

4. Remove insulation by rotating lever to other end of slot. Hold it in that position, see Fig. 5.
5. Pull the stripping tool longitudinally over entire length of insulation to be removed, see Fig. 5.

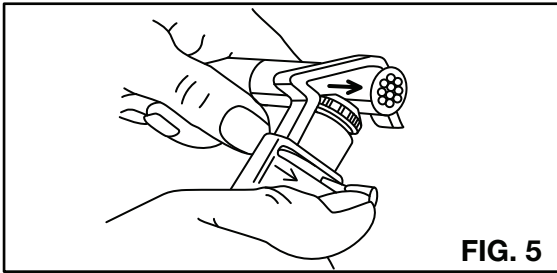

FIG. 5

6. Peel away insulation by inserting the cable support bracket into the cut line which was made in figure 5 above, see Fig. 6.

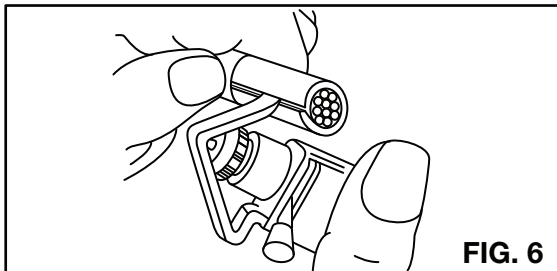

FIG. 6

7. For tough insulation, cut cable insulation in spiral form. After Step 4 rotate lever and place blade in a diagonal position (45°), and while holding this position, rotate tool around cable. Peel-off insulation, see Fig. 7.

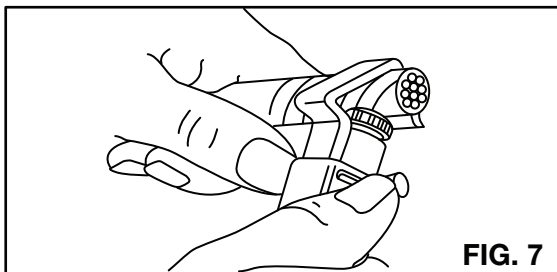

FIG. 7

For parts or service contact the Tool Service Center at 1-800-234-Tool (8665)

B. REPLACING THE BLADE



CAUTION



BLADE IS SHARP, USE CARE WHEN REPLACING.

1. Push cable support bracket up with thumb, and loosen knurled screw completely. Remove spring, blade and washer.
2. The spare blade is located in bottom of handle. To retrieve spare blade, slide pin to side. Do not lift pin out of its seat.
3. Insert spare blade with unsharpened end into slot. Replace washer, spring and nut.
4. Follow Step A1 to adjust depth of cutting blade.

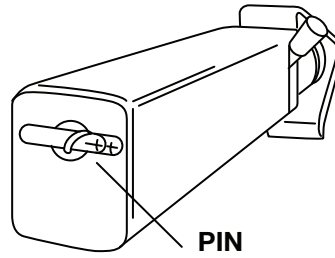

PIN

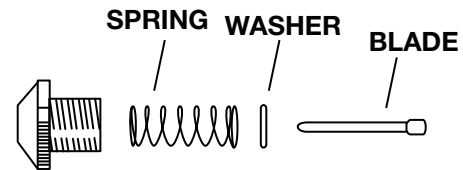

SPRING WASHER

BLADE

WARRANTY: Thomas & Betts sells this product with the understanding that the user will perform all necessary tests to determine the suitability of this product for the user's intended application. Thomas & Betts warrants that this product will be free from defects in materials and workmanship for a period of two (2) years following the date of purchase. Upon prompt notification of any warranted defect, Thomas & Betts will, at its option, repair or replace the defective product or refund the purchase price. Proof of purchase is required. Misuse or unauthorized modification of the product voids all warranties.

Limitations and Exclusions: THE ABOVE WARRANTY IS THE SOLE WARRANTY CONCERNING THIS PRODUCT, AND IS IN LIEU OF ALL OTHER WARRANTIES EXPRESS OR IMPLIED, INCLUDING BUT NOT LIMITED TO ANY IMPLIED WARRANTY OF MERCHANTABILITY OR FITNESS FOR A PARTICULAR PURPOSE, WHICH ARE SPECIFICALLY DISCLAIMED. LIABILITY FOR BREACH OF THE ABOVE WARRANTY IS LIMITED TO COST OF REPAIR OR REPLACEMENT OF THE PRODUCT, AND UNDER NO CIRCUMSTANCES WILL THOMAS & BETTS BE LIABLE FOR ANY INDIRECT, SPECIAL, INCIDENTAL OR CONSEQUENTIAL DAMAGES.

Thomas & Betts Corporation
Memphis, Tennessee
www.tnb.com