

INSTALLATION INSTRUCTIONS FOR CONCEALED SERVICE FLOOR BOX

Catalog Number: 665-AV2

IMPORTANT: Read all instructions before installing floor box, carpet plate or mounting kit.



WARNING

**ELECTRICAL HAZARD!
BE SURE POWER IS OFF!**

**MINIMUM CONCRETE DEPTH FOR THE
665-AV2 FLOOR BOX IS: 4-1/2" DEEP**

INSTALLATION INSTRUCTIONS (BEFORE CONCRETE POUR)

1. Remove the top of box, loosen (4) top screws and rotate top plate away from screws. See figure 2.
2. Install (4) ground screws. See figure 3.
3. Install conduit connectors as needed.
4. Break/trim off partition from non-metallic tunnel. Place non-metallic tunnel and partition in box. See figure 1.
5. Install (4) leveling screws. See figure 4.
6. Replace top and tighten (4) top screws. See figure 4.
7. Adjust leveling screws so that top edge of box is 1/16" below screed line. Attach conduit and secure box to form. See figure 4. Box is now ready for concrete pour.

665-AV2 ASSEMBLY

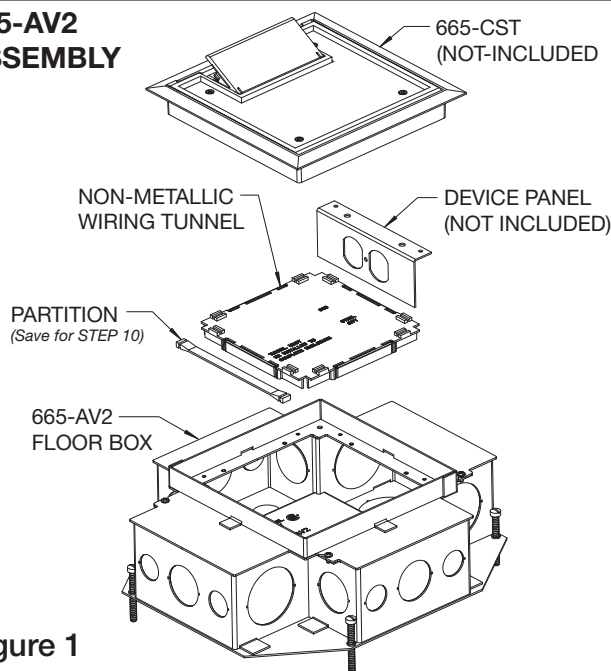

Figure 1



CAUTION

**FLOOR BOX SHOULD BE INSTALLED
BY A QUALIFIED ELECTRICIAN IN
ACCORDANCE WITH NATIONAL AND
LOCAL ELECTRICAL CODES.**

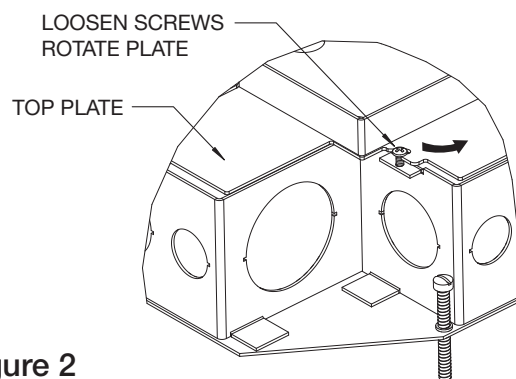

Figure 2

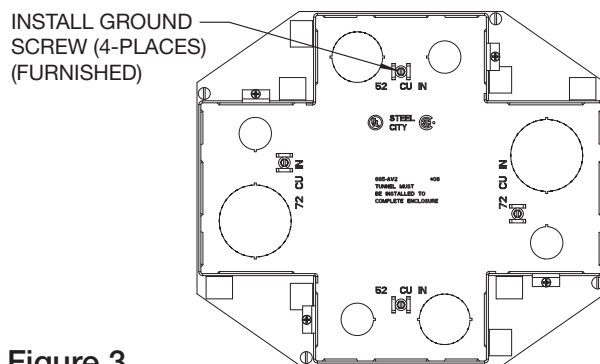

Figure 3

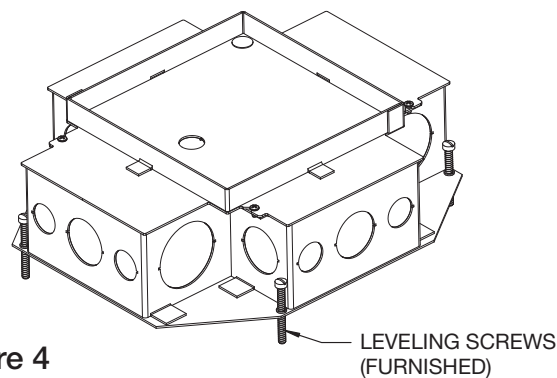

Figure 4

ACTIVATION INSTRUCTIONS (AFTER CONCRETE POUR)

8. Remove concrete from access frame. Break off plastic retainers (2) and use knockout to remove plate. See figure 5.
9. Install devices in accordance with N.E.C and prevailing local electrical codes.
10. Place non-metallic tunnel in box on top of separate services by removing selected tabs for feed through. Use the snap-in partition (step 4) to isolate low power service or to close an open tab. See figure 6.
11. Install the device panels by locating the bottom edge in the locking tabs on the non-metallic tunnel and securing the top with the (2) #6-32 screws furnished with each device plate. See figure 7.
12. Complete the activation with the 665-CST cover using the (4) #8-32 screws furnished with each cover.

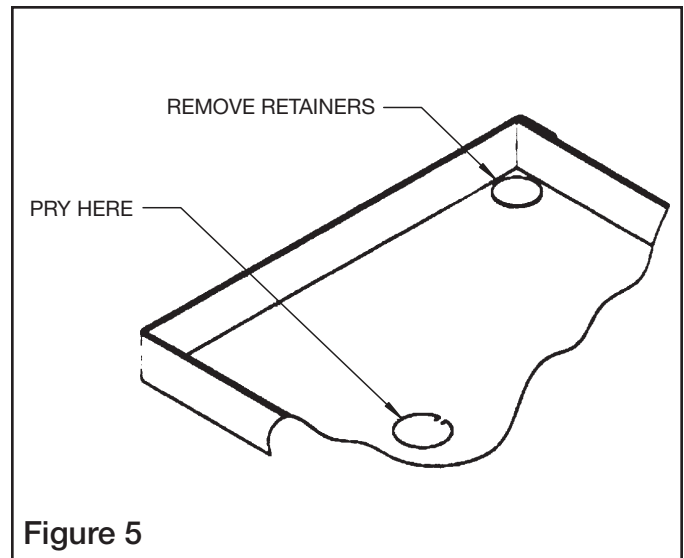

Figure 5

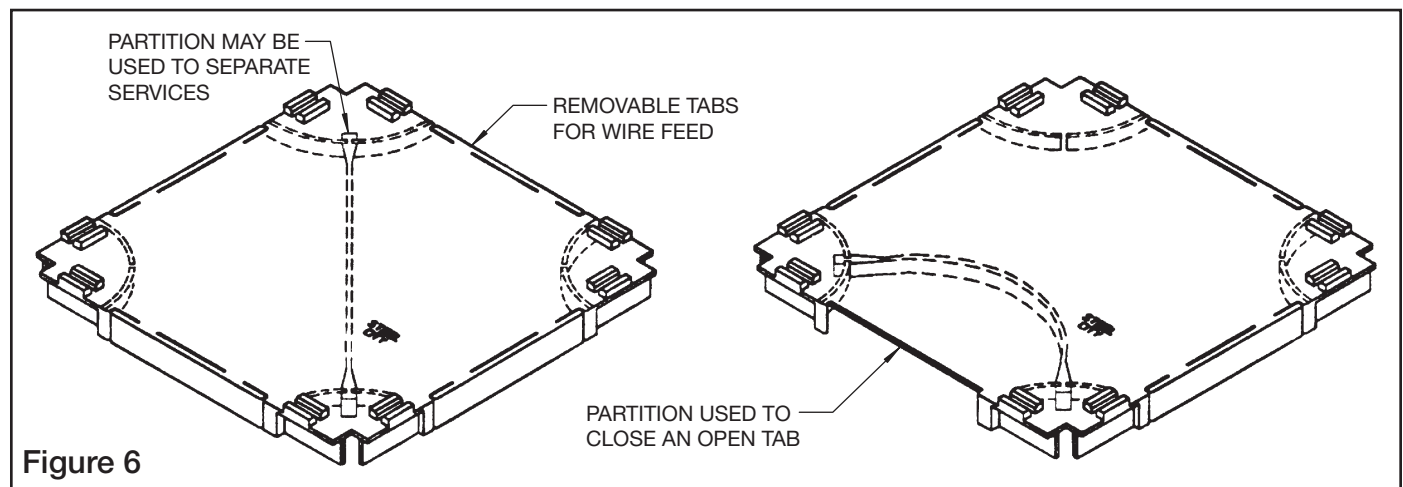

Figure 6

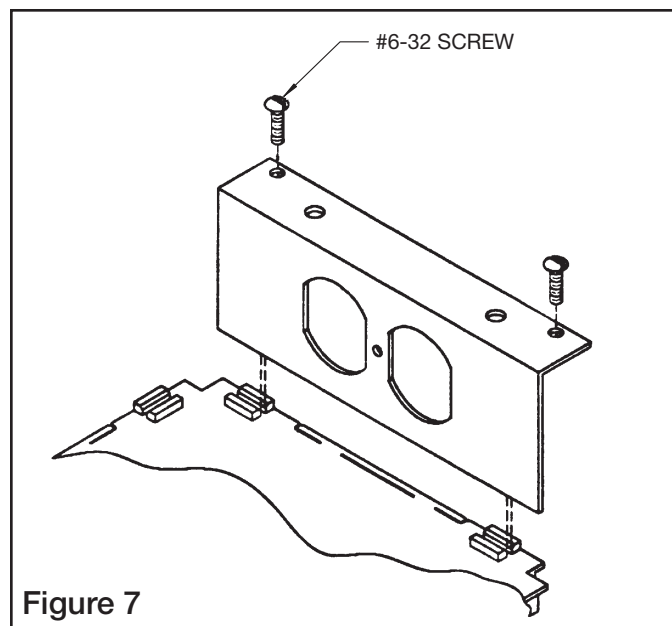

Figure 7

WARRANTY: Thomas & Betts sells this product with the understanding that the user will perform all necessary tests to determine the suitability of this product for the user's intended application. Thomas & Betts warrants that this product will be free from defects in materials and workmanship for a period of two (2) years following the date of purchase. Upon prompt notification of any warranted defect, Thomas & Betts will, at its option, repair or replace the defective product or refund the purchase price. Proof of purchase is required. Misuse or unauthorized modification of the product voids all warranties.

Limitations and Exclusions: THE ABOVE WARRANTY IS THE SOLE WARRANTY CONCERNING THIS PRODUCT, AND IS IN LIEU OF ALL OTHER WARRANTIES EXPRESS OR IMPLIED, INCLUDING BUT NOT LIMITED TO ANY IMPLIED WARRANTY OF MERCHANTABILITY OR FITNESS FOR A PARTICULAR PURPOSE, WHICH ARE SPECIFICALLY DISCLAIMED. LIABILITY FOR BREACH OF THE ABOVE WARRANTY IS LIMITED TO COST OF REPAIR OR REPLACEMENT OF THE PRODUCT, AND UNDER NO CIRCUMSTANCES WILL THOMAS & BETTS BE LIABLE FOR ANY INDIRECT, SPECIAL, INCIDENTAL OR CONSEQUENTIAL DAMAGES.