

INSTALLATION GUIDE FOR OCAL PVC COATED ST SERIES EXTERNAL GROUNDING LIQUIDTIGHT CONNECTORS

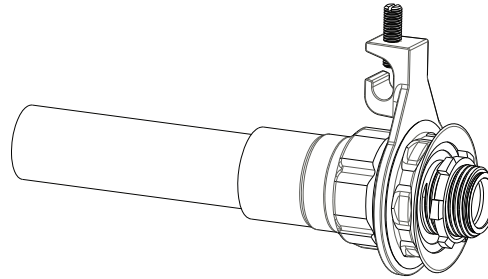

EXCLUSIVE FEATURES

- SAFE-EDGE[®] steel grounding cone protects conductors during installation (no sharp edges).
- Blue nylon insulated throat.
- Double bevel nylon sealing ring for easier installation.
- Grounding lug made of corrosion resistant naval brass.
- Suitable for use with copper conductor* only.

SPECIFICATIONS T&B LIQUIDTIGHT CONNECTORS

- Suitable as a grounding means when installed in accordance with NEC 350.60, 250.102(E)(2).
- Meets J.I.C. requirements.
- Suitable for use in hazardous locations: Class I - Div.2 per NEC 501.10(B)(2).
- Taper threads per H28 (1963 Part II, federal standards.)
- T&B laboratory tested to exceed UL/CSA/NEMA specifications and T&B quality control test specs (oscillation, drop, heat, vibration, pressure and corrosion tests).
- Meets federal specification WF406B.
- UL listed for grounding & bonding per UL 467.
- UL listed per UL 514B.
- Meets NEMA type 4X Requirements.

CAT NO. STRAIGHT	CAT NO. 45°	CAT NO. 90°	TRADE SIZE	LUG SCREW	WIRE RANGE
ST1/2GR-G	ST1/245GR-G	ST1/290GR-G	1/2"	1/4-28 UNF	#14-#4
ST3/4GR-G	ST3/445GR-G	ST3/490GR-G	3/4"		
ST1GR-G	ST145GR-G	ST190GR-G	1"		
ST11/4GR-G	ST11/445GR-G	ST11/490GR-G	1 1/4"	3/8-24 UNF	#14-2/0
ST11/2GR-G	ST11/245GR-G	ST11/290GR-G	1 1/2"		
ST2GR-G	ST245GR-G	ST290GR-G	2"		
ST21/2GR-G	ST21/245GR-G	ST21/290GR-G	2 1/2"	1/2-20 UNF	#6-4/0
ST3GR-G	ST345GR-G	ST390GR-G	3"		
ST4GR-G	ST445GR-G	ST490GR-G	4"		

*Copper Conductor - 14 AWG use solid only, all other sizes stranded or solid.

INSTALLATION INSTRUCTIONS

⚠ WARNING: BEFORE INSTALLING OR MAINTAINING, VERIFY THAT ALL CIRCUITS ARE DE-ENERGIZED.

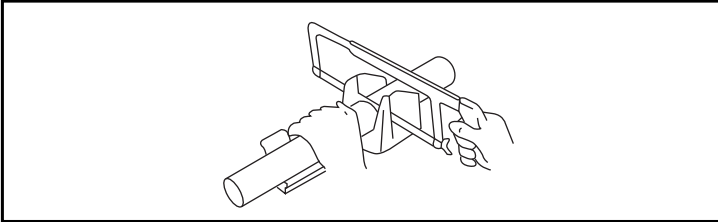

1. Properly cut the flexible conduit with a clean, square end cut.
 - Use metal jig (available from conduit manufacturer).
 - Use 32 Tooth/In. sharp hacksaw.
 - For high production use 24-32 Tooth/In. power band saw, not more than 400'/minute.

DO NOT USE ABRASIVE WHEEL

2. Remove and discard the round shape support from the PVC coating on the gland nut, slide gland and nylon sealing ring onto conduit.
3. **IMPORTANT!** Make certain open side of lug on ground ring is facing gland nut.
4. Thread ground cone into conduit and slide body onto the cone.
5. Slide glandnut and sealing ring down to body and tighten gland per torque chart below.
6. Install grounding conductor in lug, and tighten lug screw per torque table.

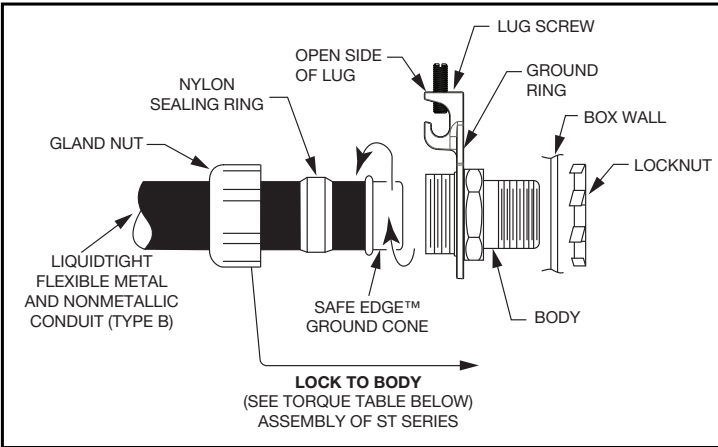

RECOMMENDED GLAND TORQUE

TRADE SIZE OF FITTING IN INCHES	TIGHTENING TORQUE IN POUND-INCHES	TRADE SIZE OF FITTING IN INCHES	TIGHTENING TORQUE IN POUND-INCHES
1/2"	300	2"	1600
3/4"	500	2-1/2"	1600
1"	700	3"	1600
1-1/4"	1000	3-1/2"	1600
1-1/2"	1200	4"	1600

TORQUE TABLE (LB. IN)

LUG CONDUCTOR	14-4	14-2/0	6-4/0
14-10	20	35	-
8	25	40	-
6-4	35	45	50
3-1	-	50	50
1/0-2/0	-	50	75
3/0-4/0	-	-	75

WARRANTY: Thomas & Betts sells this product with the understanding that the user will perform all necessary tests to determine the suitability of this product for the user's intended application. Thomas & Betts warrants that this product will be free from defects in materials or workmanship for a period of two (2) years following the date of purchase. Upon prompt notification of any warranted defect, Thomas & Betts will, at its option, repair or replace the defective product. Misuse, misapplication or modification of Thomas & Betts Products immediately voids all warranties.

Limitations and Exclusions: THE ABOVE WARRANTY IS THE SOLE WARRANTY CONCERNING THIS PRODUCT, AND IS IN LIEU OF ALL OTHER WARRANTIES EXPRESS OR IMPLIED, INCLUDING BUT NOT LIMITED TO ANY IMPLIED WARRANTY OF MERCHANTABILITY OR FITNESS FOR A PARTICULAR PURPOSE, WHICH ARE SPECIFICALLY DISCLAIMED. LIABILITY FOR BREACH OF THE ABOVE WARRANTY IS LIMITED TO COST OF REPAIR OR REPLACEMENT OF THE PRODUCT, AND UNDER NO CIRCUMSTANCES WILL THOMAS & BETTS BE LIABLE FOR ANY INDIRECT, SPECIAL, INCIDENTAL OR CONSEQUENTIAL DAMAGES.