

FER9500 SQUARE CRIMP & FER9501 HEX CRIMP COMFORT CRIMP® COMPRESSION TOOL WITH SHURE STAKE® MECHANISM For Installing Ferrules 26-8 AWG & 0.14-10mm²



IMPORTANT: Read and understand all of the instructions and safety information in this manual before operating or servicing this tool.



WARNING

KEEP ALL BODY PARTS AWAY FROM DIE NEST DURING GAGING OR CRIMPING PROCEDURE.



WARNING

HANDLES ARE NON-INSULATING. DO NOT CRIMP ON HOT ENERGIZED WIRES.

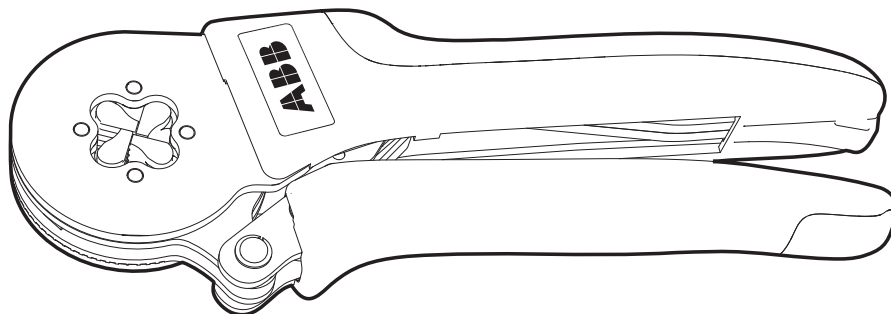

In the event the SHURE STAKE® mechanism must be released, please see Figure 3.

Figure 1

1.0

INSTRUCTIONS FOR USE

1.1

Ferrule and Crimp Installation

1. Open handles fully.
2. Position ferrule into the tool.
3. Close handles slightly to secure ferrule. Do not deform ferrule.
4. Insert stripped wire into the ferrule.
5. Close handles until the SHURE STAKE® mechanism cycle has been completed.
6. Open tool and remove crimped ferrule and wire.

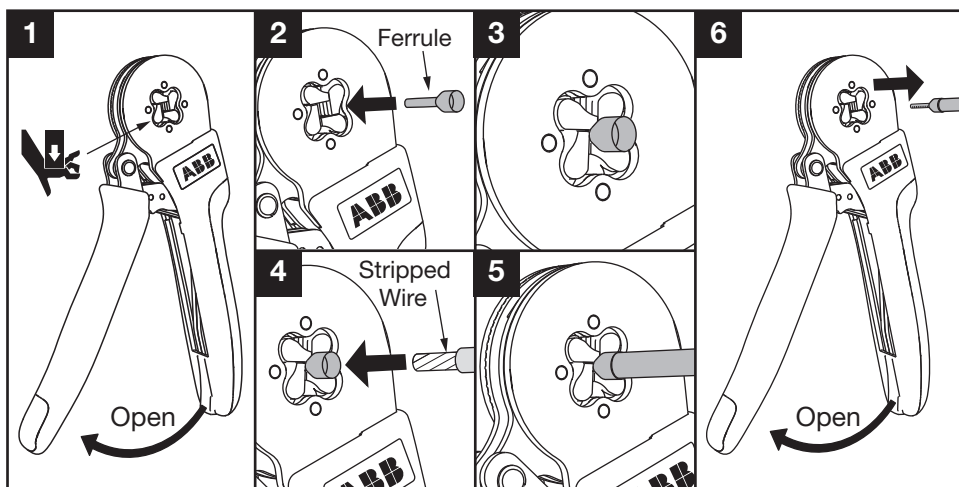



Figure 2

1.2

SHURE STAKE® Mechanism

 **WARNING** 
**KEEP ALL BODY PARTS AWAY
FROM DIE NEST DURING GAGING
OR CRIMPING PROCEDURE.**

To release the SHURE STAKE® mechanism, push up on the release bar until the ratchet teeth are disengaged.

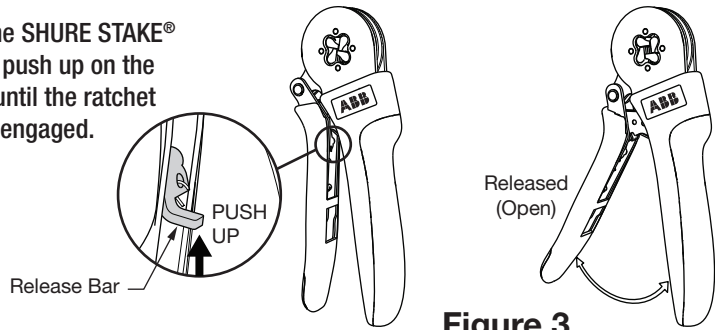

Figure 3

1.3

Maintenance

1. Remove dust, moisture, and other contaminants with a clean brush or a soft, lint-free cloth.
2. DO NOT use on objects that could damage the tool.
3. Make certain all pins, pivot points, and bearing surfaces are protected with a THIN coat of any good SAE No. 20 motor oil. DO NOT oil excessively.
4. Keep handles closed when not in use to prevent objects from becoming lodged in the crimping dies.
5. Store tool in a cool, dry area.

NOTICE: If tool does not operate properly, do no attempt repair or adjustment. Call nearest ABB Installation Products Inc. sales office to arrange for repair service. Any change, modification or alteration of the tool or use by the customer in a manner other than as specified by ABB Installation Products Inc. shall void all warranties express or implied and the customer shall, therefore, assume all liability for any damage or injury caused by said changed, modified or altered tool or improper usage of such tool.

For parts, service, repair and
calibration, contact the ABB Installation Products Inc.
Tool Service Center at 1-800-284-TOOL (8665).

IN ORDER TO OBTAIN WARRANTY SERVICE YOU MUST REGISTER YOUR
PRODUCT BY LOGGING IN ON tnb.abb.com/toolregistration. FAILURE TO
REGISTER YOUR PRODUCT VOIDS ALL WARRANTIES.

ABB Installation Products Inc.

8 Byd du Millenium, Memphis, Tennessee
B-7110 La Louvière, tnb.abb.com
Belgium USA

© 2019 ABB Installation Products Inc. All Rights Reserved.

Comfort Crimp and Shure Stake are registered trademarks of
ABB Installation Products Inc. in the United States and/or other countries.

TA05264 B Page 2 of 2