

INSTRUCTION SHEET

Seal kits, series 526x-FB

For use in Hygienic installations

T&B Liquidtight Systems™



Important

Read and understand all instructions and safety information before use. Be aware of proper usage and potential hazards.

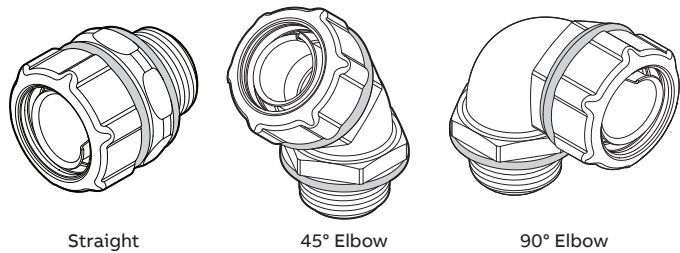

Straight

45° Elbow

90° Elbow



WARNING:

- Risk of shock, disconnect power before installation.



CAUTION:

- Product should be installed by a qualified electrician in accordance with national and local electrical codes.

Seal kit contains:

- Thread seal
- Seal gasket

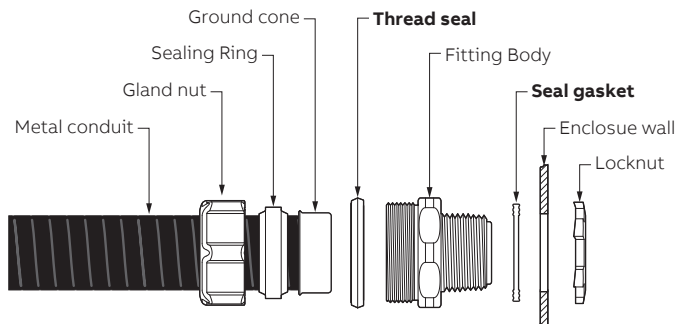
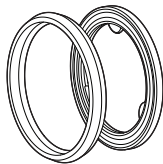

Product selection							
Seal kit Part no:	Fitting Part no:	Type	Trade size		Thread Type (NPT)	Gland nut tighten torque	
			UL	CSA		lbs-in	N-m
5262-FB	5332SST6-FB	Straight	½"	16mm	½"	300	33.9
	5342SST6-FB	45° Elbow					
	5352SST6-FB	90° Elbow					
5263-FB	5333SST6-FB	Straight	¾"	21mm	¾"	500	56.5
	5343SST6-FB	45° Elbow					
	5353SST6-FB	90° Elbow					
5264-FB	5334SST6-FB	Straight	1"	27mm	1"	700	79.1
	5344SST6-FB	45° Elbow					
	5354SST6-FB	90° Elbow					
5265-FB	5335SST6-FB	Straight	1¼"	35mm	1¼"	1,000	113.0
	5345SST6-FB	45° Elbow					
	5355SST6-FB	90° Elbow					
5266-FB	5336SST6-FB	Straight	1½"	41mm	1½"	1,200	136.0
	5346SST6-FB	45° Elbow					
	5356SST6-FB	90° Elbow					
5267-FB	5337SST6-FB	Straight	2"	53mm	2"	1,600	181.0
	5347SST6-FB	45° Elbow					
	5357SST6-FB	90° Elbow					

Note: Product must be installed in accordance with applicable national and local electrical codes.



Assembly instructions:**Seal gasket installation**

1. Thread seal gasket flush against fitting hex with tri-rib toward enclosure wall.

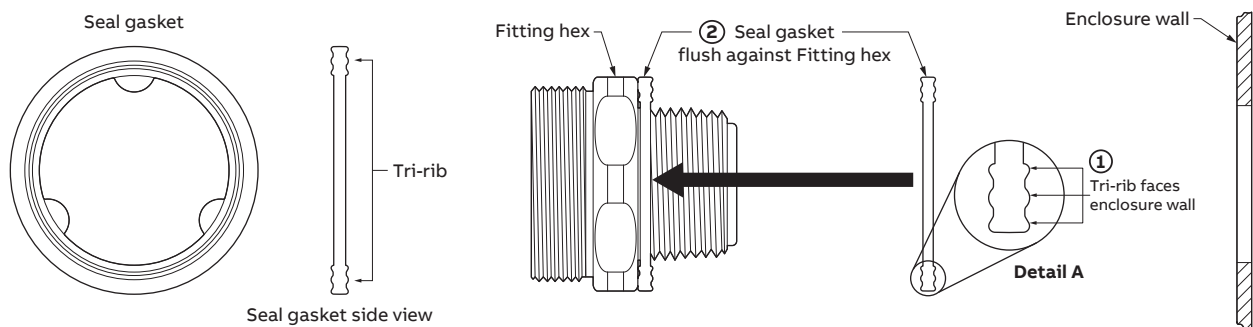
**Thread seal installation**

2. Attach thread seal flush against the fitting hex with "Circle" toward fitting hex.

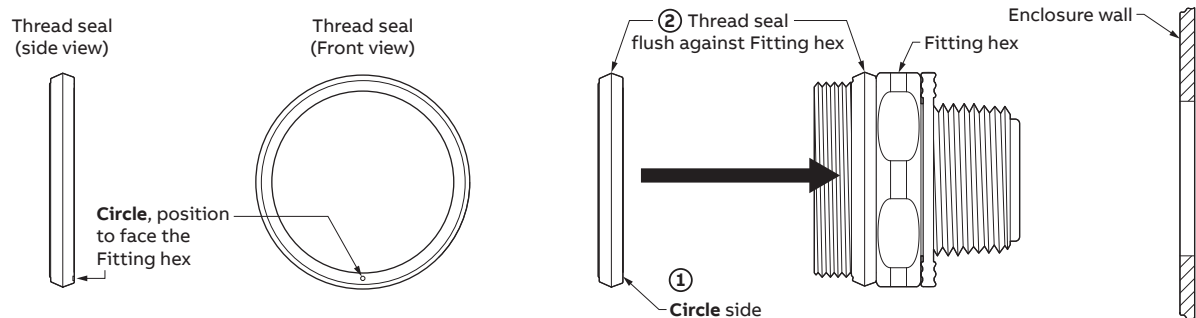
**Fitting installation**

1. Cut the end of the flexible conduit with a clean square cut.
2. Install fitting components onto conduit
3. Install fitting to enclosure wall and hand tighten locknut plus an extra $\frac{1}{4}$ turn using adjustable wrench (non-marring) type tools.

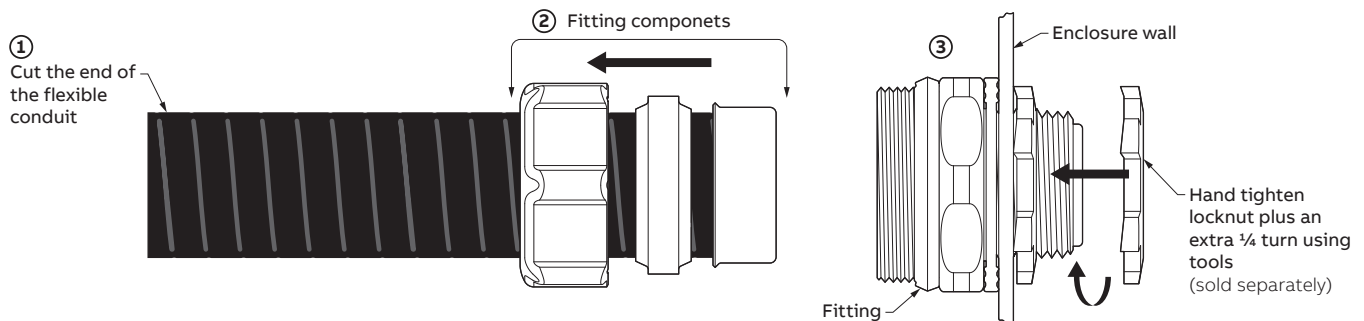
**Conduit installation**

1. Insert conduit assembly.
2. Use torque wrench to tighten gland nut onto fitting per torque values listed on table, Page 1.

⚠ Caution: To prevent damaging or marking the fitting and seal surfaces, use non-marring tools such as an adjustable wrench.

Note: Manual tightening: Turn gland nut $\frac{1}{2}$ turn from point where gland nut touches top of seal. Using non-dominant hand, attempt to rotate conduit counter clockwise. If conduit rotates, tighten gland nut in $\frac{1}{4}$ turns until conduit will no longer rotate.

