 TECHNICAL DATA SHEET

Channel Tray Straight Section Non-Metallic

T&B® Cable Tray



Channel-type tray is designed for light loads of individual wiring and pneumatic tubing. ABB offers nonmetallic cable channel in solid or ventilated straight sections.

Solid bottom tray type is the same product as the ventilated bottom tray type but with no holes.

Features:

- Available with a solid or ventilated bottom.
- Horizontal and vertical solid bottom fittings are also available to complete your system layout.
- All straight sections are pre-drilled to accept flange splice plates.
- Available in two lengths (10 and 20 feet)
- Ventilated channel-type tray has .75" (19mm) diameter holes on 9.25" (235mm) or 12" (305mm) centers staggered left and right in the web.

Materials:

- Polyester Resin
- Vinyl Ester Resin
- Polyester Resin helps protect against weathering through UV resistance, corrosion resistance and its properties are especially suitable for seawater environments.
- Vinyl Ester Resin also helps protect against weathering with enhanced performance over polyester resin in corrosive and high heat environments. At elevated temperatures, vinyl ester resin provides greater strength and toughness. In corrosive chemical service, it provides superior resistance to chemical attack.

Notes:

- Straights are provided without splice plates.
- Maximum loads are based on limiting the deflection to a value equal to 1/120 of the span. For ventilated tray-type, maximum loading reduced by 10%.

Product selection

Part no:	Bottom Type	Material	Series	A (IN)	B (IN)	C (IN)	D (IN)	Span (FT)	Max Load (LB/FT)	Max Deflection (IN)
NM-FCCVP-02-120	Ventilated	Polyester Resin	02	2"	1"	3/16"	120"	5'	4.0	0.5"
NM-FCCVP-03-120	Ventilated	Polyester Resin	03	3"	1"	3/16"	120"	5' 8'	3.9 1.0	0.5" 0.8"
NM-FCCVP-04-120	Ventilated	Polyester Resin	04	4"	1-1/8"	1/4"	120"	8' 10'	2.8 1.5	0.8" 1.0"
NM-FCCVP-06-120	Ventilated	Polyester Resin	06	6"	1-5/8"	1/4"	120"	10'	2.8	1.0"
NM-FCCVP-08-120	Ventilated	Polyester Resin	08	8"	1-3/4"	5/16"	120"	10'	5.2	1.0"
NM-FCCVP-02-240	Ventilated	Polyester Resin	02	2"	1"	3/16"	240"	5'	4.0	0.5"
NM-FCCVP-03-240	Ventilated	Polyester Resin	03	3"	1"	3/16"	240"	5' 8'	3.9 1.0	0.5" 0.8"
NM-FCCVP-04-240	Ventilated	Polyester Resin	04	4"	1-1/8"	1/4"	240"	8' 10'	2.8 1.5	0.8" 1.0"
NM-FCCVP-06-240	Ventilated	Polyester Resin	06	6"	1-5/8"	1/4"	240"	10'	2.8	1.0"
NM-FCCVP-08-240	Ventilated	Polyester Resin	08	8"	1-3/4"	5/16"	240"	10'	5.2	1.0"
NM-FCCNP-02-120	Non-ventilated	Polyester Resin	02	2"	1"	3/16"	120"	5'	4.0	0.5"
NM-FCCNP-03-120	Non-ventilated	Polyester Resin	03	3"	1"	3/16"	120"	5' 8'	3.9 1.0	0.5" 0.8"
NM-FCCNP-04-120	Non-ventilated	Polyester Resin	04	4"	1-1/8"	1/4"	120"	8' 10'	2.8 1.5	0.8" 1.0"
NM-FCCNP-06-120	Non-ventilated	Polyester Resin	06	6"	1-5/8"	1/4"	120"	10'	2.8	1.0"
NM-FCCNP-08-120	Non-ventilated	Polyester Resin	08	8"	1-3/4"	5/16"	120"	10'	5.2	1.0"
NM-FCCNP-02-240	Non-ventilated	Polyester Resin	02	2"	1"	3/16"	240"	5'	4.0	0.5"
NM-FCCNP-03-240	Non-ventilated	Polyester Resin	03	3"	1"	3/16"	240"	5' 8'	3.9 1.0	0.5" 0.8"
NM-FCCNP-04-240	Non-ventilated	Polyester Resin	04	4"	1-1/8"	1/4"	240"	8' 10'	2.8 1.5	0.8" 1.0"
NM-FCCNP-06-240	Non-ventilated	Polyester Resin	06	6"	1-5/8"	1/4"	240"	10'	2.8	1.0"
NM-FCCNP-08-240	Non-ventilated	Polyester Resin	08	8"	1-3/4"	5/16"	240"	10'	5.2	1.0"
NM-FCCVV-02-120	Ventilated	Vinyl Ester Resin	02	2"	1"	3/16"	120"	5'	4.0	0.5"
NM-FCCVV-03-120	Ventilated	Vinyl Ester Resin	03	3"	1"	3/16"	120"	5' 8'	3.9 1.0	0.5" 0.8"
NM-FCCVV-04-120	Ventilated	Vinyl Ester Resin	04	4"	1-1/8"	1/4"	120"	8' 10'	2.8 1.5	0.8" 1.0"
NM-FCCVV-06-120	Ventilated	Vinyl Ester Resin	06	6"	1-5/8"	1/4"	120"	10'	2.8	1.0"
NM-FCCVV-08-120	Ventilated	Vinyl Ester Resin	08	8"	1-3/4"	5/16"	120"	10'	5.2	1.0"
NM-FCCVV-02-240	Ventilated	Vinyl Ester Resin	02	2"	1"	3/16"	240"	5'	4.0	0.5"
NM-FCCVV-03-240	Ventilated	Vinyl Ester Resin	03	3"	1"	3/16"	240"	5' 8'	3.9 1.0	0.5" 0.8"
NM-FCCVV-04-240	Ventilated	Vinyl Ester Resin	04	4"	1-1/8"	1/4"	240"	8' 10'	2.8 1.5	0.8" 1.0"
NM-FCCVV-06-240	Ventilated	Vinyl Ester Resin	06	6"	1-5/8"	1/4"	240"	10'	2.8	1.0"
NM-FCCVV-08-240	Ventilated	Vinyl Ester Resin	08	8"	1-3/4"	5/16"	240"	10'	5.2	1.0"
NM-FCCNV-02-120	Non-ventilated	Vinyl Ester Resin	02	2"	1"	3/16"	120"	5'	4.0	0.5"
NM-FCCNV-03-120	Non-ventilated	Vinyl Ester Resin	03	3"	1"	3/16"	120"	5' 8'	3.9 1.0	0.5" 0.8"
NM-FCCNV-04-120	Non-ventilated	Vinyl Ester Resin	04	4"	1-1/8"	1/4"	120"	8' 10'	2.8 1.5	0.8" 1.0"
NM-FCCNV-06-120	Non-ventilated	Vinyl Ester Resin	06	6"	1-5/8"	1/4"	120"	10'	2.8	1.0"
NM-FCCNV-08-120	Non-ventilated	Vinyl Ester Resin	08	8"	1-3/4"	5/16"	120"	10'	5.2	1.0"
NM-FCCNV-02-240	Non-ventilated	Vinyl Ester Resin	02	2"	1"	3/16"	240"	5'	4.0	0.5"
NM-FCCNV-03-240	Non-ventilated	Vinyl Ester Resin	03	3"	1"	3/16"	240"	5' 8'	3.9 1.0	0.5" 0.8"
NM-FCCNV-04-240	Non-ventilated	Vinyl Ester Resin	04	4"	1-1/8"	1/4"	240"	8' 10'	2.8 1.5	0.8" 1.0"
NM-FCCNV-06-240	Non-ventilated	Vinyl Ester Resin	06	6"	1-5/8"	1/4"	240"	10'	2.8	1.0"
NM-FCCNV-08-240	Non-ventilated	Vinyl Ester Resin	08	8"	1-3/4"	5/16"	240"	10'	5.2	1.0"

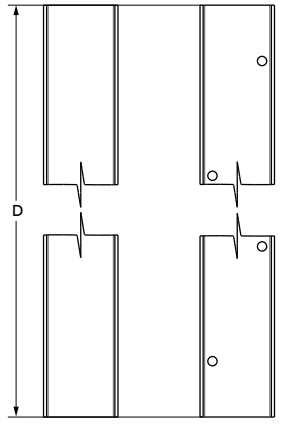
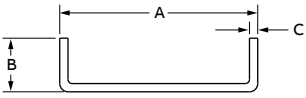

VENTILATED CHANNEL-TYPE HAS 3/4 Ø HOLES

Note: Product must be installed in accordance with applicable national and local electrical codes.

Part number information

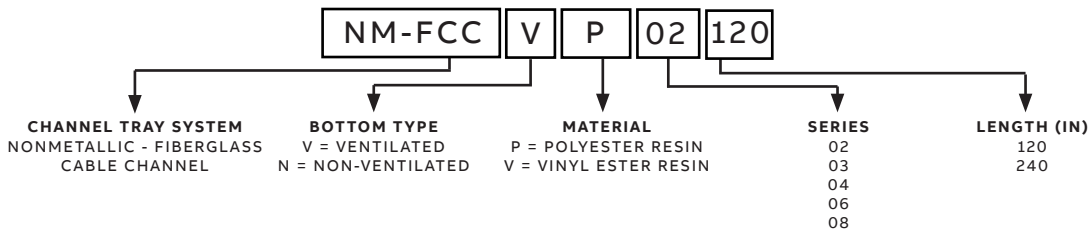

tnb.abb.com (US/Latin America)
tnb.ca.abb.com (Canada)
abb.com

We reserve the right to make technical changes or modify the contents of this document without prior notice. With regard to purchase orders, the agreed particulars shall prevail. ABB does not accept any responsibility whatsoever for potential errors or possible lack of information in this document.

We reserve all rights in this document and in the subject matter and illustrations contained therein. Any reproduction – in whole or in part – is forbidden without prior written consent of ABB. Copyright© 2020 ABB. All rights reserved.