

TECHNICAL DATA SHEET - INTERACTIVE PDF

Insert, 90°

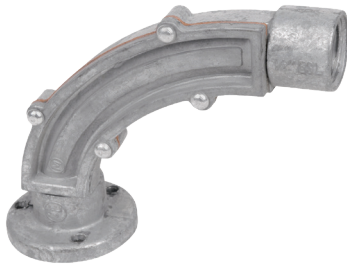

Die cast aluminum 90° insert for use with rigid and IMC conduit systems.

Certifications / Standards:



3-Part Specification End User Tools

Features & Benefits:

- Flush design leaves no broken or bent stubs for easy removal of undamaged forms
- Design permits simplified in-slab work
- Design leaves a neat, uncluttered job
- Product includes cautionary seal pad

Applications:

- Permits in-slab ceiling drops and floor mounts in poured concrete
- Designs permit prefabrication of in-slab conduit system

Product selection - inches

Part no.	Hub Size	A	B	C	D	E
ESL-1	1/2"	1.89	1.02	4.41	1.02	3.66
ESL-2	3/4"	2.13	1.14	4.53	1.14	3.72
ESL-3	1"	2.44	1.46	4.68	1.46	3.86

Note: Product must be installed in accordance with applicable national and local electrical codes.

Conforms to:

- UL 514
 - UL File: E23018
- CSA C22.2 No.18
 - CSA File: 16807

Material

- Body: Die cast zinc alloy

