

# Kindorf®

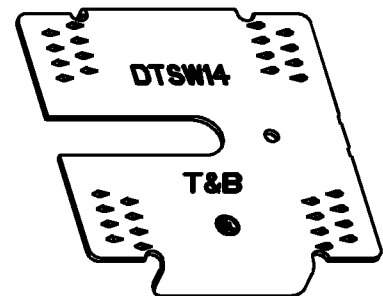

ALL DIMENSIONS ARE FOR REFERENCE ONLY

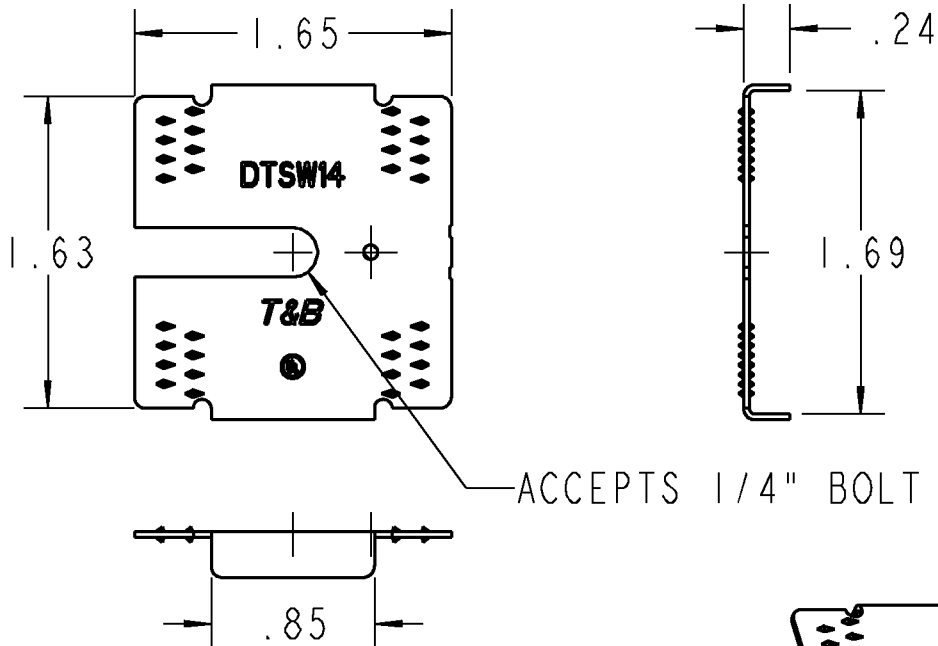

CATALOG No. DTSW14

MATERIAL: .03" THICK STEEL  
HEAT TREATMENT: CASE HARDENED  
FINISH: TIN-PLATED

FOR BONDING ANODIZED ALUMINUM PANELS TO STEEL  
OR ALUMINUM STRUT (1-1/2" AND 1-5/8" WIDTH), OR  
STRUCTURAL MEMBERS WITH A MINIMUM CROSS  
SECTION OF .354 SQ. IN.

COMPLIES WITH UL467 SHORT TIME CURRENT TEST  
FOR A #6 AWG GROUND WIRE.

TO BE USED WITH A 1/4" BOLT TORQUED TO  
100 LBS-IN MINIMUM.

REFERENCE T&B DOCUMENT TA04634 FOR COMPLETE  
INSTALLATION INSTRUCTIONS.

#### GENERAL NOTES

1. ALL DIMENSIONS ARE FOR REFERENCE ONLY.
2. DIMENSIONS IN BRACKETS [ ] ARE IN METRIC UNITS.

#### REVISIONS

- |   |  |
|---|--|
| 1 | SEE ERN (2012998) FOR APPROVAL SIGNATURES & RELEASE DATE.<br>PROJECT NO: XD55948 |
|---|--|

**Thomas & Betts**  
www.tnb.com

DESCRIPTION: **SOLAR GROUNDING TRANSITION WASHER**

ORIGINAL PROJECT NO / ( ERN NO )  
XD55948 / ( 2012330 )

SHEET NO:  
1 OF 1

REV. NO:  
1

DRAWING NO:  
WSD-000591