

# Ty-Rap

## NOTICE:

DUE TO VARIATIONS IN DETECTION EQUIPMENT SENSITIVITY AND DIFFERENCES IN FOOD DENSITY, DETECTABILITY TESTING OF THIS PRODUCT FOR THE INTENDED FOOD PROCESSING ENVIRONMENT IS RECOMMENDED BEFORE USING.

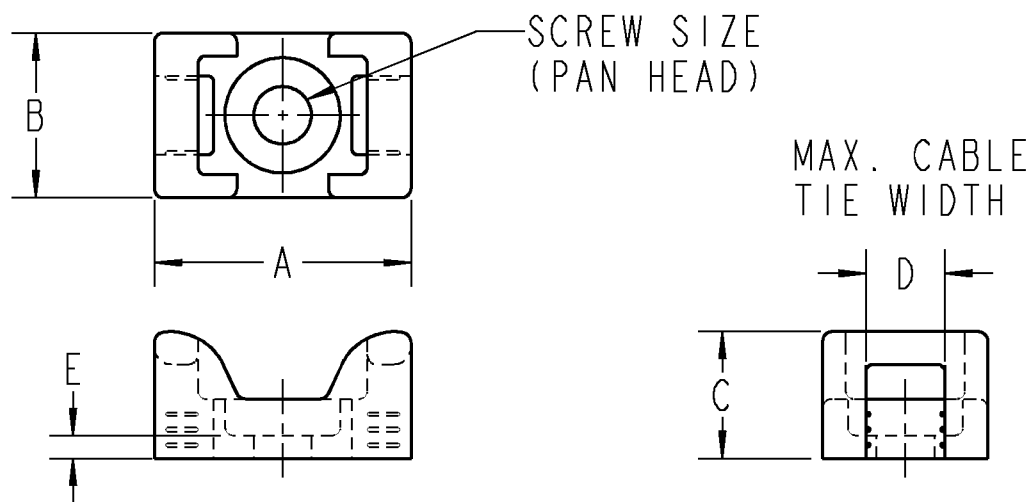

## MATERIAL:

NDT SUFFIX - NYLON

PDT SUFFIX - POLYPROPYLENE

COLOR: BLUE

BULK PACK CATALOG NUMBERS IDENTIFIED IN TABLE,  
STANDARD PACK HAS A 5 AFTER THE TC (e.g. TC5140-NDT).

DETECTABLE WITH METAL AND X-RAY DETECTION EQUIPMENT.

TC142-PDT	.92	.56	.42	.30	.20	#10
TC142-NDT	.92	.56	.42	.30	.20	#10
TC141-PDT	.67	.43	.33	.19	.16	#6
TC141-NDT	.67	.43	.33	.19	.16	#6
TC140-PDT	.56	.34	.27	.09	.14	#4
TC140-NDT	.56	.34	.27	.09	.14	#4
CATALOG No.	A	B	C	D	E	SCREW SIZE

### GENERAL NOTES

- ALL DIMENSIONS ARE FOR REFERENCE ONLY.
- DIMENSIONS IN BRACKETS [ ] ARE IN METRIC UNITS.

### REVISIONS

SEE ERN (\*\*\*\*) FOR APPROVAL SIGNATURES & RELEASE DATE.  
PROJECT NO: \*\*\*\*

**Thomas & Betts**  
www.tnb.com

DESCRIPTION: **DETECTABLE MOUNTING BASES,  
SADDLE SUPPORT**

ORIGINAL PROJECT NO / ( ERN NO )  
009D000294 / (2013989)

SHEET NO:  
1 OF 1

REV. NO:  
\*\*

DRAWING NO:  
**WSD-001086**