

Superstrut®

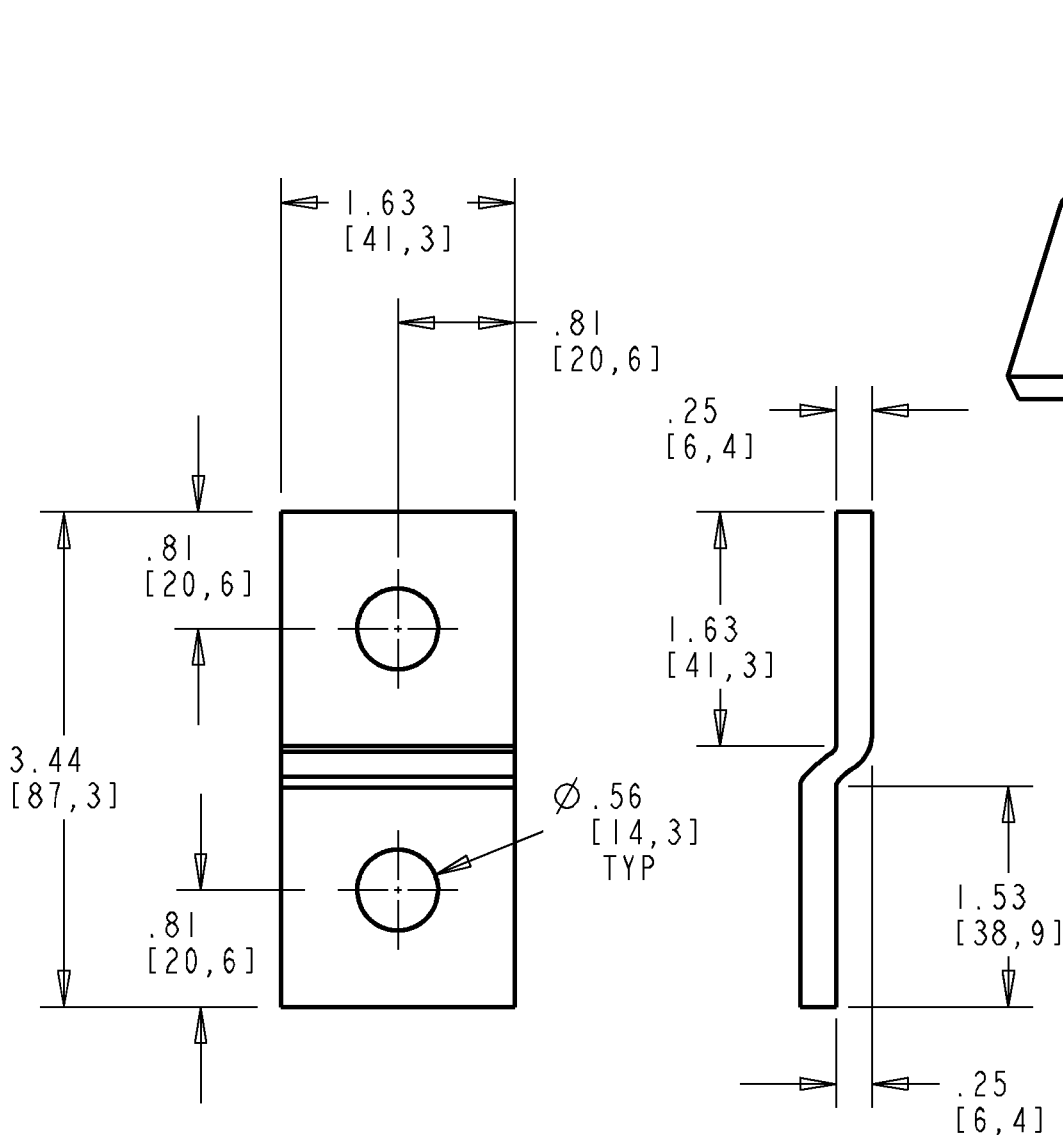

NOTES:

- 1.) CAT. NO. A219
- 2.) MATERIAL: HOT ROLLED CARBON STEEL
- 3.) FINISH: ZINC DICHROMATE ELECTROPLATE (GALV-KROM)
- 4.) STANDARD BOLT: (9/16" HOLE) 1/2" HEX HEAD CAP SCREW 15/16" LONG
(15/16" LENGTH MAY BE USED WITH ALL SERIES CHANNEL)
- 5.) BRACKET MATERIAL/FINISH IS RoHS COMPLIANT
- 6.) DIMENSIONS ARE INCH / mm

GENERAL NOTES

1. ALL DIMENSIONS ARE FOR REFERENCE ONLY.
2. DIMENSIONS IN BRACKETS [] ARE IN METRIC UNITS.

REVISIONS

SEE ERN (****) FOR APPROVAL SIGNATURES & RELEASE DATE.
PROJECT NO: ****

Thomas & Betts
www.tnb.com

DESCRIPTION: **2-HOLE OFFSET SPLICE FITTING
SUPERSTRUT**

ORIGINAL PROJECT NO / (ERN NO)

XM400032 / (2014306)

SHEET NO:

1 OF 1

REV. NO:

DRAWING NO:

WSD-001109