

# Color-Keyed®

CATALOG NO. 54116B

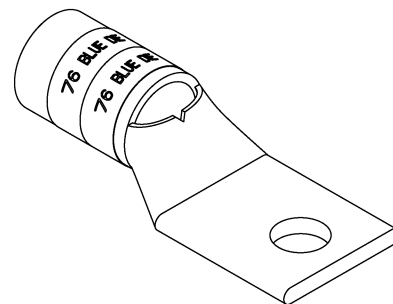
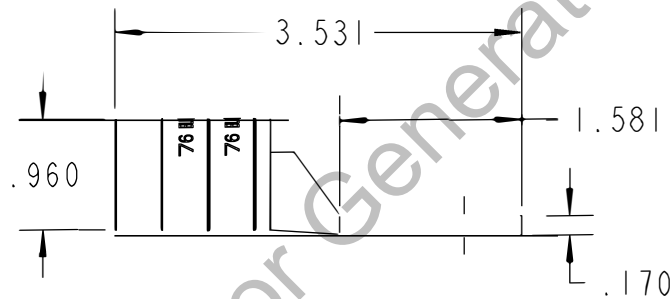
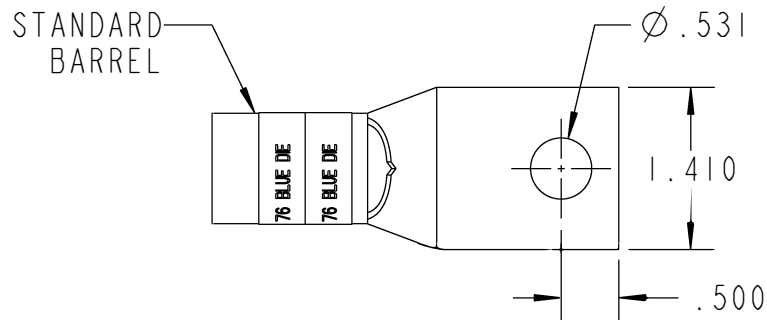

WIRE SIZE: 400 MCM  
MATERIAL: HIGH CONDUCTIVITY COPPER  
FINISH: TIN PLATED

## GENERAL NOTES

1. ALL DIMENSIONS ARE FOR REFERENCE ONLY.
2. DIMENSIONS IN BRACKETS [ ] ARE IN METRIC UNITS.

## REVISIONS

\*\* SEE ERN ( \*\*\*\* )  
FOR APPROVAL SIGNATURES  
& RELEASE DATE.  
PROJECT NO: \*\*\*\*

**Thomas & Betts**  
www.tnb.com

DESCRIPTION:

**1 HOLE LUG**

ORIGINAL PROJECT NO / ( ERN NO )

/ ( )

SHEET NO:

1 OF 1

REV. NO:

0

DRAWING NO: WSD-002234

**54116B**