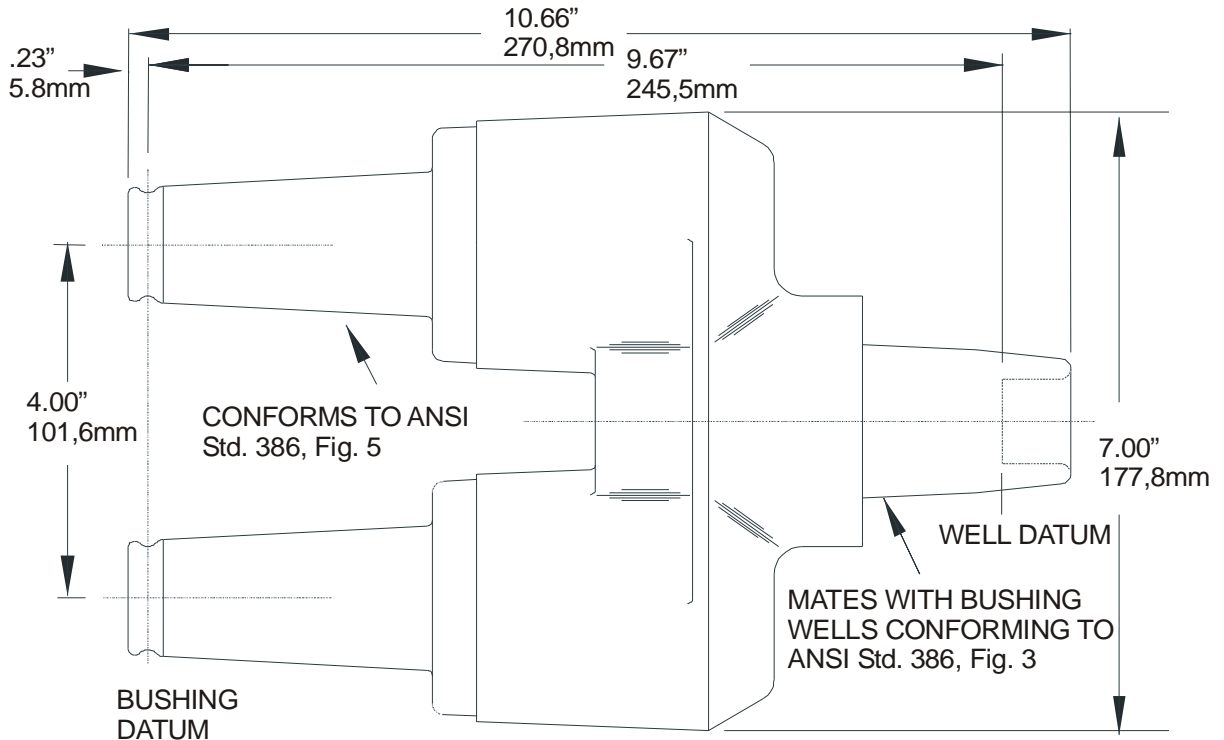

**PRODUCT SPECIFICATION SHEET**
**I T C**
**15kV 200A Loadbreak Feed-Thru Insert**
**1602A3R**

The Elastimold 1602A3R feed-thru bushing insert is fully rated with two 15kV class, 200 Amp load break bushing interfaces. The feed-thru bushing insert fits a standard ANSI bushing well interface and provides the capability of creating a tap position in an existing apparatus installation and transforming a radial-feed transformer into a loop-feed unit.

### Features

- Transform radial feed transformer into loop-feed unit.
- Provide extra tap for elbow arrester connection
- 15kV, 200 Amp loadbreak rated.
- Peroxide-cured insulation and jacket.

### Ordering Instructions:

To order, specify number **1602A3R** bushing insert.

The 1602A3R bushing insert includes the following:

|                              |            |
|------------------------------|------------|
| 1 – Bushing insert           | 1602A3R    |
| 2 – Protective shipping cap  | 1601-APC-1 |
| 1 – Bail assembly            | 2702-16    |
| 3 – Lubricant                | 82-08      |
| 1 – Installation instruction | IS-0063    |

### Ratings

per ANSI/IEEE Standard 386

15kV Voltage Class

8.3kV Max Phase-to-Ground - Operating Voltage

14.4kV Max Phase-to-Phase

95kV BIL - Impulse Withstand (1.2 x 50 microsecond wave)

34kV AC - One minute Withstand

53kV DC - 15 Minutes Withstand

11kV AC - Corona Extinction @ 3p.C.sensitivity

200 Amp - Continuous and Loadbreak

10kA Sym - 10 Cycles Momentary & Fault Close

### Applications

It may be used as the bushing interface for connecting shielded cable to the following:

- |                            |              |
|----------------------------|--------------|
| * Sub-surface transformers | * Generators |
| * Pad mounted transformers | * Switchgear |
| * Regulators               | * Reclosers  |

Designed for use as an apparatus bushing interface and provide extra tap connection, the 1602A3R is easily installed in an ELASTIMOLD universal bushing well and mated with an appropriate ELASTIMOLD product.