

PRODUCT SPECIFICATION SHEET		I T C
15kV 200A Loadbreak Feed-Thru		164FT

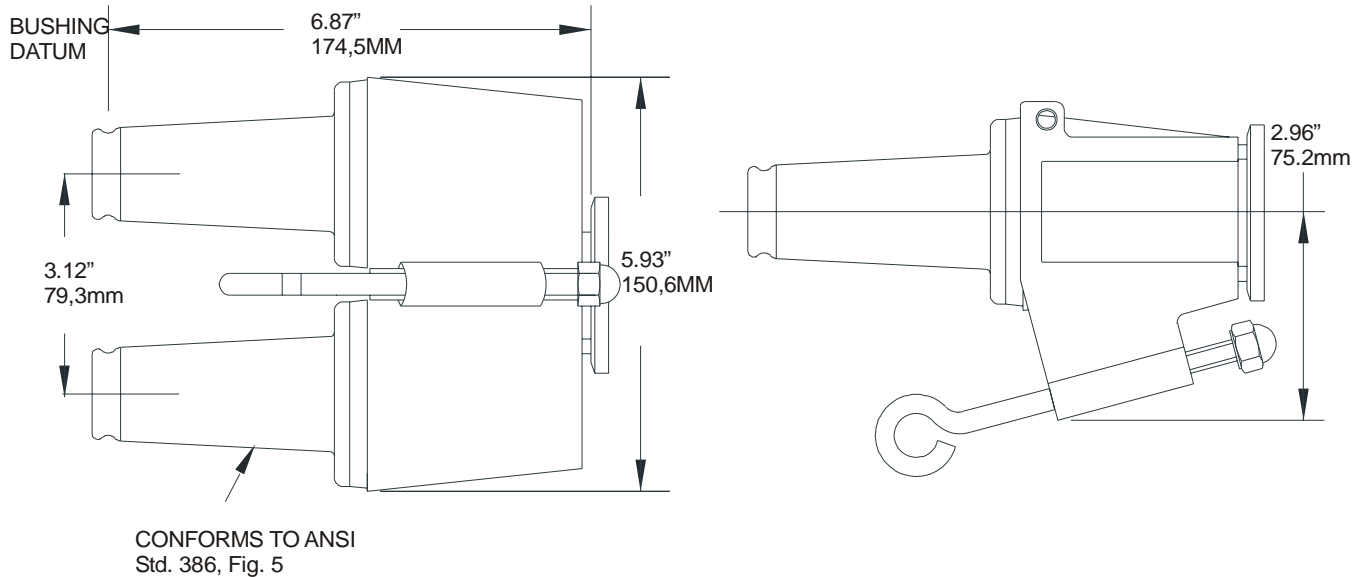

The 164FT feed-thru is a fully shielded, fully submersible, separable insulated connector designed for energized operation. It is suitable for use on 15kV class loadbreak systems. When used in conjunction with 15kV class elbow connectors, the 164FT provides the circuit with the loadbreak junction point. Testing and grounding of the circuit is accomplished when the 164FT is used in conjunction with the 370TR and 160GLR. When used in conjunction with a 160DR the 164FT can be used to isolate and "dead-end" the circuit. The 164FT is designed to mate with the following Elastimold products:

- 165LR/166LR elbow connector
- 370TR test rod
- 160GLR grounding elbow
- 160DR/DRG insulated cap

Ratings

- per ANSI/IEEE Standard 386
- 15kV Voltage Class
- 8.3kV Max Phase-to-Ground - Operating Voltage
- 14.4kV Max Phase-to-Phase
- 95kV BIL - Impulse Withstand (1.2 x 50 microsecond wave)
- 34kV AC - One minute Withstand
- 53kV DC - 15 Minutes Withstand
- 11kV AC - Corona Extinction @ 3p.C.sensitivity
- 200 Amp - Continuous and Loadbreak
- 10kA Sym - 10 Cycles Momentary & Fault Close

Ordering Instructions:

To order, specify number **164FT** Feed-thru

The 164FT Feed-thru includes the following:

- | | |
|------------------------------|------------|
| 1 - Feed-thru body | 164FT |
| 2 - Protective shipping cap | 1601-APC-1 |
| 2 - Lubricant | 82-08 |
| 1 - Installation instruction | IS-0376 |