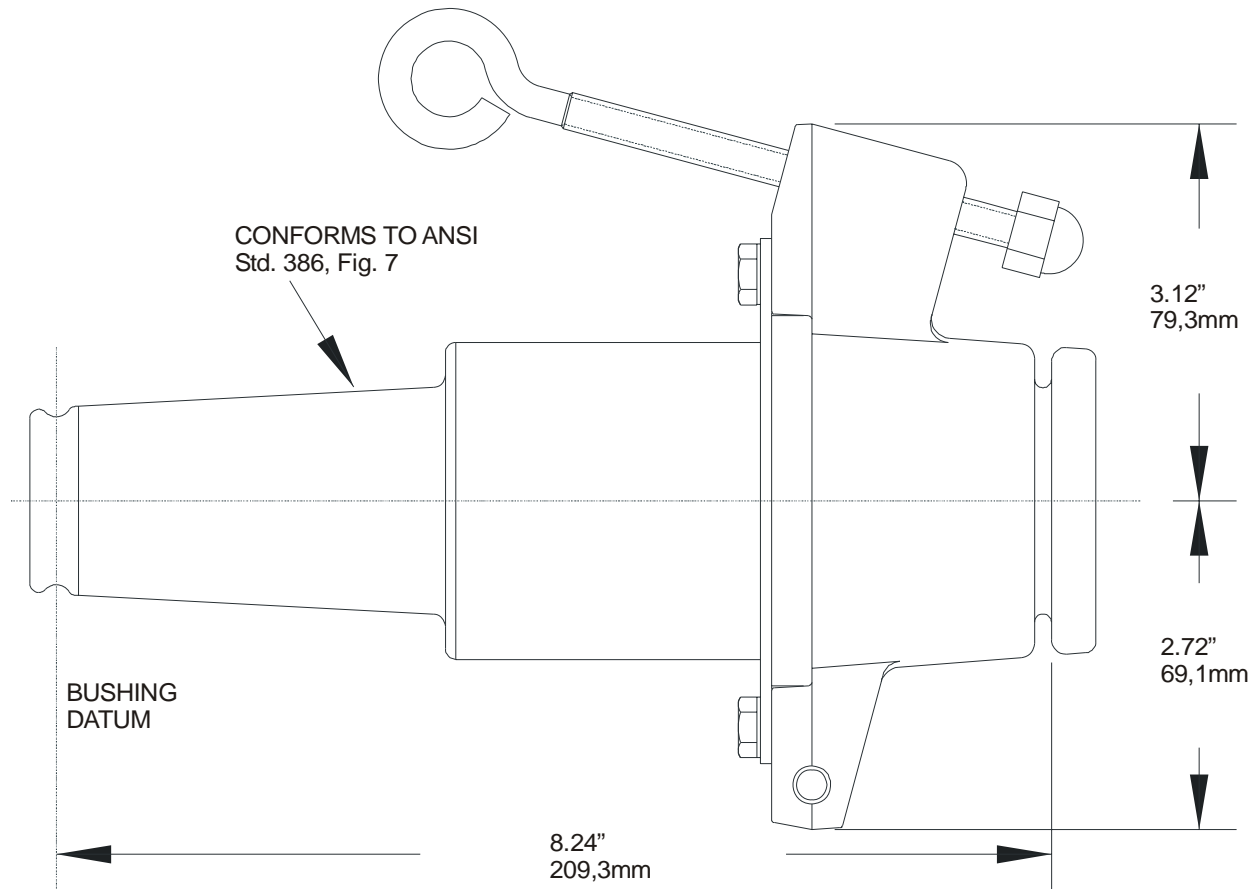

PRODUCT SPECIFICATION SHEET
I T C
25kV 200A Insulated Parking Bushing
272SOP

Ratings:

The Elastimold 272SOP Insulated Parking Bushing is equipped with a 25kV class, 200 Amp loadbreak interface, a cast aluminum bracket for insertion into a standard parking stand and hot stick operable mounting hardware. The 272SOP are inserted into the parking stand with an insulated hot stick and secured in place. Mating Elastimold 25kV class Loadbreak Elbows can then be removed from the equipment and placed on the 272SOP to provide a fully shielded and fully submersible connection. Provisions for grounding the 272SOP mounting bracket are included.

per ANSI/IEEE Standard 386
 25kV Voltage Class
 15.2kV Max Phase-to-Ground - Operating Voltage
 26.3kV Max Phase-to-Phase
 125kV BIL - Impulse Withstand (1.2 x 50 microsecond wave)
 40kV AC - One minute Withstand
 78kV DC - 15 Minutes Withstand
 19kV AC - Corona Extinction @ 3p.C.sensitivity
 200Amp - Continuous and Loadbreak
 10kA Sym - 10 Cycles Momentary & Fault Close

Features:

- 25kV, 200 Amp loadbreak rated.
- Molded EPDM interface.
- Cast aluminum bracket with slotted end, which inserts into parking stand.
- 5/16"-18 Stainless steel eyebolt with brass cap nut allows hot stick installation and firmly secures the 272SOP into the mating parking stand.
- Set screw ground connection with 1/4" diameter thru hole.

Ordering Instructions:

To order, specify number **272SOP** Insulated Parking Bushing

The 272SOP includes the following:

1 - Insulated parking bushing	272SOP
1 - Protective shipping cap	2701-41
2 - Lubricant	82-08
1 - Installation instruction	IS-0078