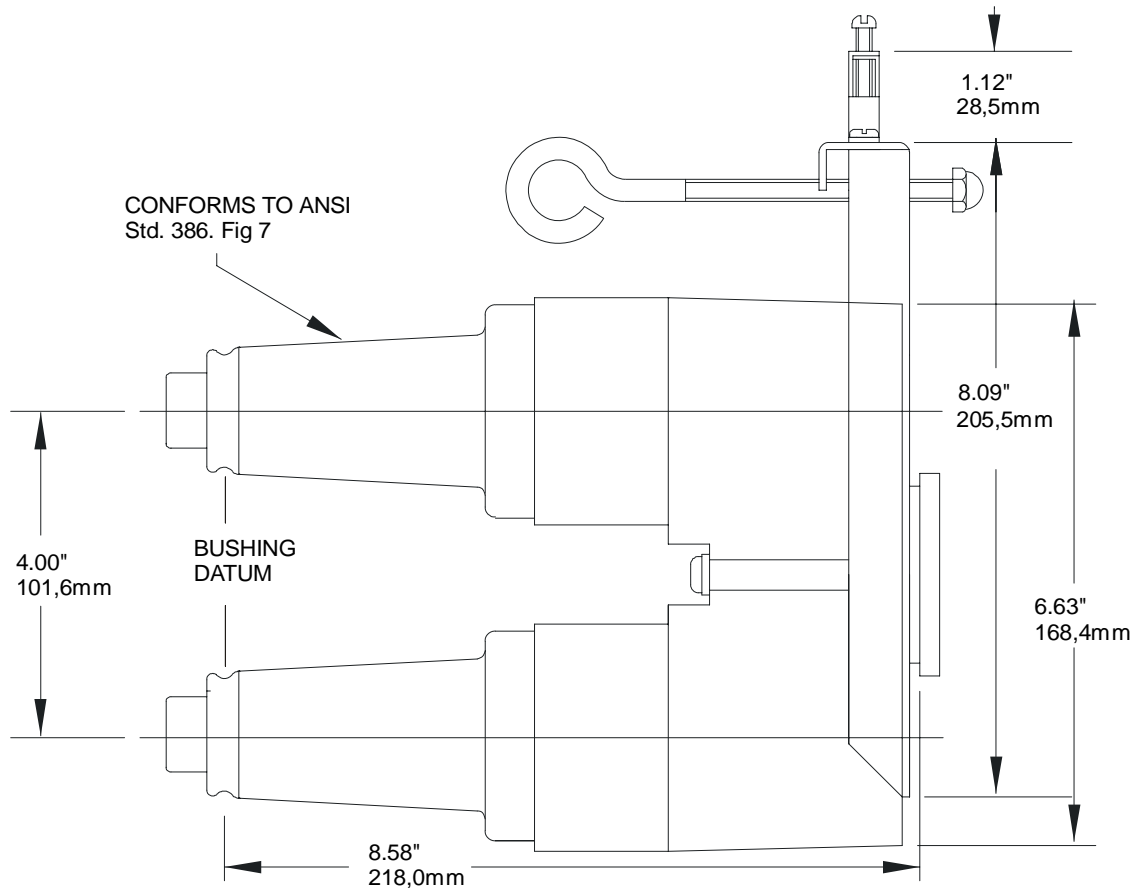

PRODUCT SPECIFICATION SHEET
I T C
25kV Loadbreak Vertical Feed-Thru
274FTV

Ratings:

The 274FTV vertical feed-thru is a space saving design for congested areas inside transformers or switchgear. The 274FTV is a fully shielded, fully submersible, separable insulated connector designed for energized operation. It is suitable for use on 25kV class loadbreak systems. When used in conjunction with 25kV class elbow connectors, the 274FTV provides the circuit with the loadbreak junction point. Testing and grounding of the circuit is accomplished when the 274FTV is used in conjunction with the 370TR and 370GLR. When used in conjunction with a 273/274DRG the 274FTV can be used to isolate and "dead-end" the circuit. The 274FTV is designed to mate with the following Elastimold products:

- 273LR/274LR elbow connector
- 370TR test rod
- 370GLR grounding elbow
- 273DRG/274DRG insulated cap

per ANSI/IEEE Standard 386
 25kV Voltage Class
 15.2kV Max Phase-to-Ground - Operating Voltage
 26.3kV Max Phase-to-Phase
 125kV BIL - Impulse Withstand (1.2 x 50 microsecond wave)
 40kV AC - One minute Withstand
 78kV DC - 15 Minutes Withstand
 19kV AC - Corona Extinction @ 3p.C.sensitivity
 200 Amp - Continuous and Loadbreak
 10kA Sym - 10 Cycles Momentary & Fault Close

Ordering Instructions:

To order, specify number **271FTV** Vertical Feed-thru

The 271FTV Vertical Feed-thru includes the following:

1 - Feed-thru body	274FTV
2 - Protective shipping cap	2701-41
2 - Lubricant	82-08
1 - Installation instruction	IS - 0401