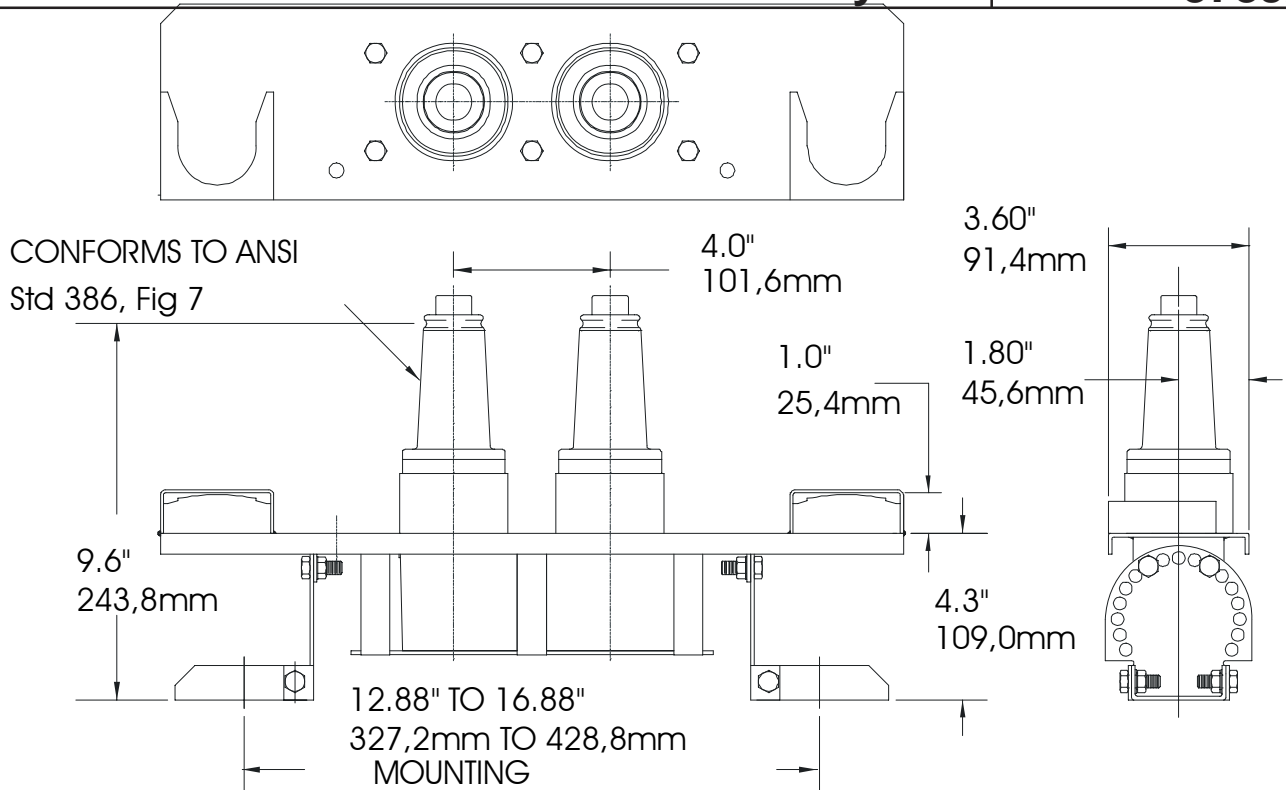

**PRODUCT SPECIFICATION SHEET**
**I T C**
**35kV 200A Loadbreak Junction - 2 Way**
**373J2**

ELASTIMOLD junctions are designed for subsurface, vault or padmount applications and can be used for sectionalizing, looping, tapping, and equipment bypass. Junctions are designed to mate with other ELASTIMOLD products including:

- 375LR elbow connector
- 376LR elbow connector
- 370GLR grounding elbow
- 370TR test rod
- 375DR/376DRG insulated cap

ELASTIMOLD loadbreak junctions, provide a fully shielded, fully submersible, separable, insulated assembly designed for energized operation. They are suitable for use on 35-kV class distribution systems, and rated for 200-ampere loadmake/loadbreak operation. Junctions are equipped with universal brackets that accommodate curved or flat surfaces and provide tilt mounting angles from 0° to 90° in 15° increments.

### Ratings

per ANSI/IEEE Standard 386  
 35kV Voltage Class 1 Ø and 3 Ø  
 21.1kV Max Phase-to-Ground - Operating Voltage  
 36.6kV Max Phase-to-Phase  
 150kV BIL - Impulse Withstand (1.2 x 50 microsecond wave)  
 50kV AC - One minute Withstand  
 103kV DC - 15 Minutes Withstand  
 26kV AC - Corona Extinction @ 3p.C.sensitivity  
 200 Amp - Continuous and Loadbreak  
 10kA Sym - 10 Cycles Momentary & Fault Close.

### Ordering Instructions:

Specify **373J2** for 35kV, 200 Amp, 2-way Loadbreak Junction  
 Add "-5" at the end of the catalog number for junctions with "U" style mounting straps only.

Add "-6" at the end of the catalog number for bracket only with "U" strap and mounting hardware.

### The 373J2 2-way Junction kit contains the following:

1 - Basic Junction	373J2
2 - Protective shipping cap	2701-41
2 - Tube, lubricant	82-08
1 - Installation instruction	IS-0078